

*Stay safe and be free*

# **TUFF BUILT**

**PRODUCTS INC.**

By



**DIVERSIFIED FALL  
PROTECTION**



**BEST**  
HOIST.

**BEST**  
SAFETY  
SYSTEMS.

**Sky-X-Stand**

**EXOSPHERE**  
ANCHOR

## **Product Catalogue**

## Product Categories:

1. Winches & Accessories
2. Self Retracting Lifelines & Accessories
3. Tripods & Accessories
4. Hoists, Davits & Accessories
5. Portable Bases
6. Permanent Bases
7. Pole Hoists & Horizontal Entry Systems
8. Beam Clamps & Anchor Points
9. Mobile Stair Systems with Fall Protection
10. A-Frames & Quad-Frames
11. Mobile Horizontal Rail Systems
12. Portable Anchor Points & Restricted Space Davit Systems
13. Handrailing Systems & Accessories
14. Horizontal Rail & Trolley Systems
15. Rescue Systems & Accessories
16. Portable Fall Arrest Anchor Posts
17. Tuff-Step Access Systems & Accessories
18. Exosphere Customizable Portable Fall Protection Anchor Systems
19. Exosphere Highway Trailer Fall Protection Anchor System
20. Exosphere All Terrain 4x4 Fall Protection Anchor System

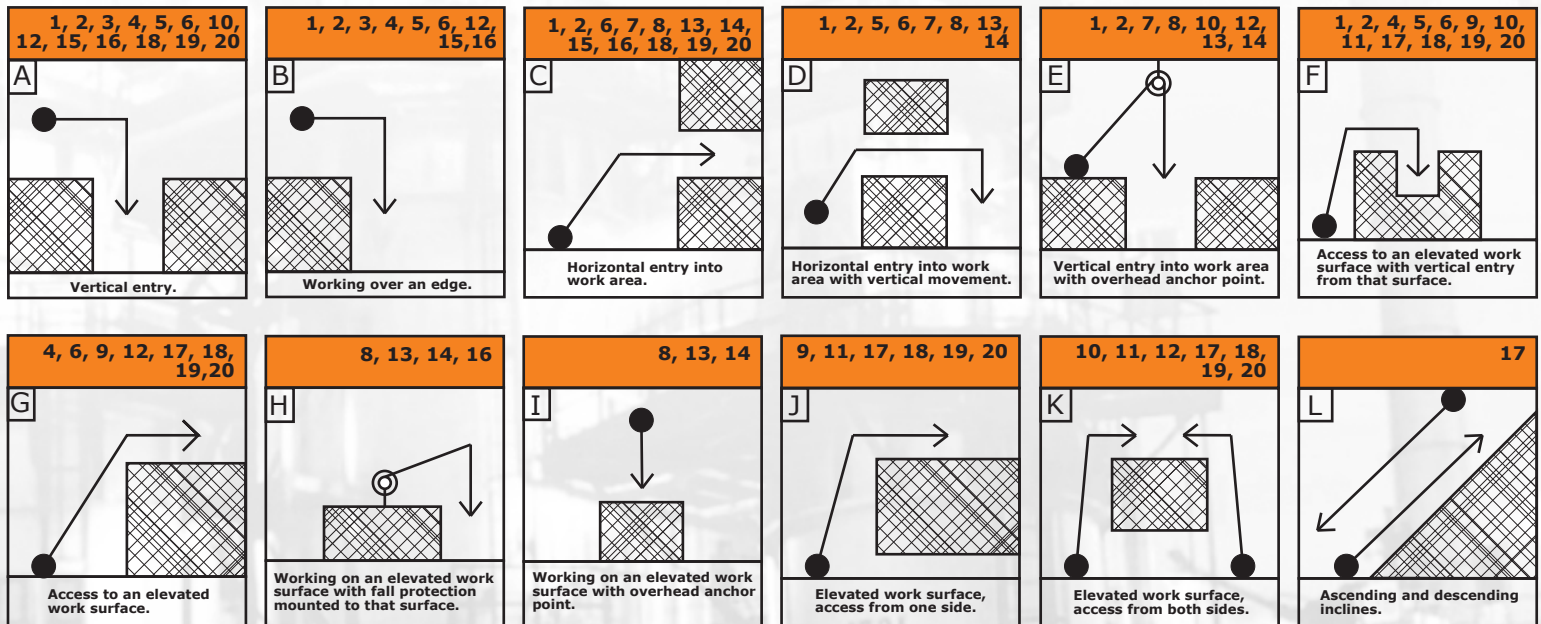

Tuff Built Products Inc. is owned and operated by some of the world's most innovative contributors in the fall protection safety industry.

Over 50 years of collective experience in the design, manufacture, and installation of cutting edge solutions to industry problems, our developments have been the benchmark models for products in our industries.

From portable anchorage structures to flexible access solutions, we set the standard to which our competitors aspire.

Our expansive product line offers solutions to your most challenging requirements, and our Best Design Service can tailor the finished product to your exact specifications.

We respect the unique needs of your organization and we look forward to the opportunity to help make your workplace safer.

The pictograms above represent the range of different applications that Best Hoist, Best Safety Systems, Sky-X-Stand Systems, and Exosphere Anchor Systems can be used in. The numbers located above each pictogram represent the "product categories" for the application.

Select your application then go to the "product categories" that fits that application.

# Winches and Accessories

Our Pro-Series winches are available in a variety of cable capacities with your choice of cable size and type. These winches are specifically designed for personnel handling in a wide range of confined space, fall protection, and rescue applications.

## Features of Pro-Series Winches

- 1 Ergonomic Carrying Handle
- 2 Brake Wear Indicator
- 3 Cranking Handle (removable)
- 4 Secondary Brake  
(Meets ANSI Z359.4 - 2013 requirements)
- 5 Hardened Steel Drive Gears
- 6 High Impact Resistant Plastic Cover



The Pro-Series Winches come standard with "Tuff-Klik" mounting brackets.

## Best Hoist Pro-1 Series Winch



Part #	Cable	Cable Length	Weight	Price
60217	3/16" (5mm) Stainless Steel	60 ft. (18m)	30.8 lbs (14kgs)	
60218		100 ft. (30m)	33.4 lbs (15.2kgs)	
60219	3/16" (5mm) Galvanized Steel	60 ft. (18m)	30.8 lbs (14kgs)	
60220		100 ft. (30m)	33.4 lbs (15.2kgs)	

## Best Hoist Pro-2 Series Winch



Part #	Cable	Cable Length	Weight	Price
60221	3/16" (5mm) Stainless Steel	150 ft. (45m)	39.6 lbs (18Kgs)	
60222		200 ft. (60m)	42.8 lbs (19.5Kgs)	
60223	3/16" (5mm) Galvanized Steel	150 ft. (45m)	39.6 lbs (18Kgs)	
60224		200 ft. (60m)	42.8 lbs (19.5Kgs)	

## Best Hoist Pro-3 Series Winch



Part #	Cable	Cable Length	Weight	Price
60225	3/16" (5mm) Stainless Steel	250 ft. (76m)	49 lbs (22.3Kgs)	
60226		300 ft. (90m)	52.2 lbs (23.8Kgs)	
60227	3/16" (5mm) Galvanized Steel	250 ft. (76m)	49 lbs (22.3Kgs)	
60228		300 ft. (90m)	52.2 lbs (23.8Kgs)	

Specifications are subject to change without notice.



## Best Hoist Winch Power Drive Attachments

Part #	Description	Includes	Price
60197	Kit, 4:1 Gear Reduction w/ Direct Drive	60189, 60110 w/60188	
60193	Kit, Direct Drive	60186 w/60187	
60194	Kit, Direct Drive w/Overload Clutch	60126 w/60187	
60195	Kit, 4:1 Gear Reduction w/Overload Clutch	60126, 60110 w/60188	
60196	Kit, Direct Drive	60189 w/60187	
60248	Pro Series Winch Crank Handle (Removable)	Handle and Snap Ring	



## Best Hoist Winch Bags

Part #	Description	Price
40005	Bag, Pro-1/Pro-2	
40006	Bag, Pro-3	





# Self Retracting Lifelines and Accessories

Tuff Built's "Tuff-Line" Self Retracting Lifelines (SRL's) are available in various lengths and lifeline constructions, with or without retrieval capability for rescue after a fall.

All Tuff-Line SRL's have a Maximum Arrest Force (MAF) rating of 1350 lbs (612kg) or less.

## Tuff-Line Self Retracting Lifeline (SRL)

Part #	Cable Type	Cable Length	Weight	Price
60051	3/16 (5mm) Galvanized Steel	20 ft. (6m)	10.3 lbs (4.7kgs)	
60053		32 ft. (10m)	11.7 lbs (5.3kgs)	
60055		49 ft. (15m)	19.6 lbs (8.9kgs)	



## Tuff-Line Self Retracting Lifeline with Retrieval Capability (SRLR)

Part #	Cable Type	Cable Length	Weight	Price
60056	3/16 (5mm) Stainless Steel	49 ft. (15m)	22.5 lbs (10.2kgs)	
60057	3/16 (5mm) Galvanized Steel	49 ft. (15m)	22.5 lbs (10.2kgs)	



### Features

1. Corrosion-resistant stainless steel and aluminum internal components.
2. Dual Swivels (unit top and snap hook).
3. Cranking Handle (retrieval units only).
4. Rugged cast aluminum body.
5. Integrated load indicator in snap hook.

This product complies with  
**CE** EN 1496 : 2006  
 BSEN 360 : 2002  
 ANSI Z117.1  
 ANSI/ASSE Z359.1  
 A10.32-2004  
 OSHA 1926.502

## Tuff-Line SRL / SRLR Mounting Brackets

Part #	Description	Price	Used With
60035	Carabiner (ANSI, CSA, EN)		Can be used with any of the Tuff-Line Series of SRLs
60155	Bracket, SRL Tuff Klik Mount (32)		60053
60176	Bracket, SRLR Tuff Klik Mount w/Carry Handle (49/R)		60055, 60057, and 60056
60154	Bracket, SRL Tuff Klik Mount (49/R)		60055, 60056, and 60057
60326	Tagline, 20 ft (6m)		60051
60327	Tagline, 32 ft (10m)		60053
60328	Tagline, 49 ft (15m)		60055, 60056, and 60057

**Other manufacturer brackets available. Please call us for more information.**



Other styles and/or custom designs are available. Please call for more information.

## SRL / Winch Carrying Bag



Part #	Description	Price
40005	Bag, Pro-1/Pro-2	

Ideal bag for carrying your Winch/SRL from one work site to another without getting any damage.

# Tripods and Accessories

Tripods remain the first choice for economical compliance in many basic confined space and fall arrest applications. Tuff Built's Pro-Series Tripods provide outstanding value in a lightweight package featuring "Tuff-Klik" pin-less adjustment.



This Product complies with  
 CE EN 1496:2006  
 CE EN795  
 ANSI Z117.1  
 ANSI/ASSE Z359.4  
 OSHA 1910.146



Collapsed View



World's only  
3-Stage Tripod!

Featuring Tuff Built Products Inc.'s

**TUFF-KLIK.**

Pin-Less Technology

Part #	Description	Price
40001	Bag, Pro-1 & Pro-3 Tripods	
40002	Bag, Pro-2 Tripods	
30173	Tripod Pulley Assembly (extra pulley for Pro-2 & Pro-3)	
30198	Tripod Pulley Assembly (extra pulley for Pro-1)	
30168	Safety Chain for Pro-1 Tripods	
30169	Safety Chain for Pro-2 Tripods	
30170	Safety Chain for Pro-3 Tripods	
30172	Tripod feet with rubber	
60101	Bracket, Tuff Klik Structure #2 (for use on Pro-1 & Pro-3 Tripods)	
60102	Bracket, Tuff Klik Structure #3 (for use on Pro-2 Tripods)	
30175	Single Re-Direct Pulley	

**Other manufacturer brackets available. Please call us for more information.**

## Best Hoist Pro Series Tripods

Part #	Model	Maximum Height	Collapsed Height	Weight (Lbs/Kgs)	Price
30013	Pro-1 Tripod, 7 ft 2 Stage (w/ One pulley and chain)	89" (2.26m)	59" (1.49m)	32.0 / 14.5	
30012	Pro-2 Tripod, 7 ft 3 Stage (w/ One pulley and chain)	89" (2.26m)	48" (1.22m)	36.5 / 16.6	
30014	Pro-3 Tripod, 10 ft 3 Stage (w/ One pulley and chain)	119" (3.02m)	61" (1.55m)	43.5 / 19.8	
20008	Pro-4 Tripod Rescue, 10 ft 3 Stage (w/ Rescue Base)	119" (3.02m)	61" (1.55m)	82.0 / 37.3	
30307	Compliance Tripod, 7 ft 2 Stage	89" (2.26m)	58" (1.47m)	38.0 / 17.2	

Specifications are subject to change without notice.



## Pro-1, 7 ft-2 Stage

Part#	Model	Max. Height	Collapsed Height	Weight	Price
30013	Pro-1, 7ft 2 Stg (w/One pulley & Chain)	89" (2.26m)	59" (1.49m)	32lbs (14.5kgs)	

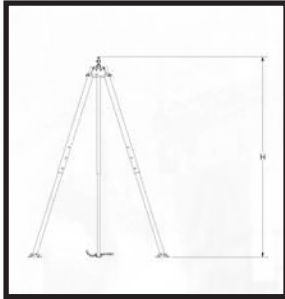

Package #	Package Contains	Winch #	SRL #	SRL Bracket #	#2 Structure Bracket	Pulley #	Weight	Price
20016	Tripod w/ winch & winch bracket	60217	—	—	60101 (1)	—	65.7lbs (30.0kgs)	
20017	Tripod w/ winch, winch bracket, SRL-R, SRL bracket & pulley	60217	60057	60154	60101 (2)	30198	93.5lbs (42.2kgs)	
20018	Tripod w/ SRL-R & SRL bracket	—	60057	60154	60101 (1)	—	59.9lbs (27.2kgs)	
20019	Tripod w/ hanging SRL-R	—	60057	60035	—	—	55.0lbs (25.0kgs)	
20020	Tripod w/ winch, winch bracket & hanging SRL-R	60217	60057	60035	60101 (1)	—	88.7lbs (40.3kgs)	

## Pro-2, 7 ft-3 Stage

Part#	Model	Max. Height	Collapsed Height	Weight	Price
30012	Pro-2, 7ft 3 Stg (w/One pulley & Chain)	89" (2.26m)	48" (1.22m)	36.5lbs (16.6kgs)	

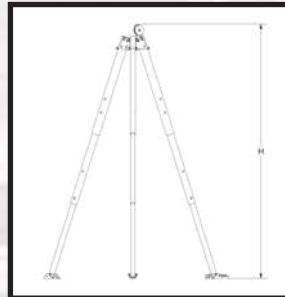

Package #	Package Contains	Winch #	SRL #	SRL Bracket #	#3 Structure Bracket	Pulley #	Weight	Price
20004	Tripod w/ winch & winch bracket	60217	—	—	60102 (1)	—	70.2lbs (32.0kgs)	
20021	Tripod w/ winch, winch bracket, SRL-R, SRL bracket & pulley	60217	60057	60154	60102 (2)	30173	98.0lbs (44.5kgs)	
20022	Tripod w/ SRL-R & SRL bracket	—	60057	60154	60102 (1)	—	64.4lbs (29.4kgs)	
20023	Tripod w/ hanging SRL-R	—	60057	60035	—	—	59.5lbs (27.1kgs)	
20024	Tripod w/ winch, winch bracket & hanging SRL-R	60217	60057	60035	60102 (1)	—	93.2lbs (42.4kgs)	

## Pro-3, 10 ft-3 Stage

Part#	Model	Max. Height	Collapsed Height	Weight	Price
30014	Pro-3, 10ft 3 Stg (w/One pulley & Chain)	119" (3.02m)	61" (1.55m)	43.5lbs (19.8kgs)	

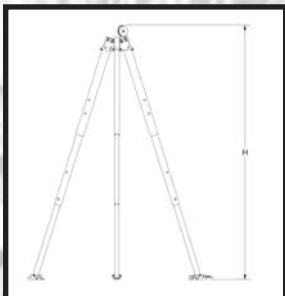

Package #	Package Contains	Winch #	SRL #	SRL Bracket #	#2 Structure Bracket	Pulley #	Weight	Price
20005	Tripod w/ winch & winch bracket	60217	—	—	60101 (1)	—	78.0lbs (35.1kgs)	
20025	Tripod w/ winch, winch bracket, SRL-R, SRL bracket & pulley	60217	60057	60154	60101 (2)	30173	105.0lbs (47.7kgs)	
20026	Tripod w/ SRL-R & SRL bracket	—	60057	60154	60101 (1)	—	71.2lbs (32.5kgs)	
20027	Tripod w/ hanging SRL-R	—	60057	60035	—	—	66.5lbs (30.3kgs)	
20028	Tripod w/ winch, winch bracket & hanging SRL-R	60217	60057	60035	60101 (1)	—	101.0lbs (45.6kgs)	

# Hoists, Davits, and Accessories

Tuff Built's Pro-Series Davits are available in a wide variety of heights and reaches, with features ranging from basic position jobs to fully rotational and adjustable davit arms for multiple applications. The Pro-Series davits feature "Tuff-Klik" pin-less adjustment, which eliminates lost or damaged locking pins.

## Pro-1 Series Davits

The Pro-1 Series Davits are designed to be small and lightweight, while at the same time being strong, reliable, and providing economical packages. The Pro-1 Series Davits also FOLD UP for easy moving and storage.

Part #	Model	Reach	Height	Winch/SRL Mount	Weight	Price
30015	Pro-1 Davit w/Pulley	19" (48cm)	73" (185cm)	Top	18.5lb (8.4kgs)	
30016	Pro-1 Plus Davit w/Pulley's	19" (48cm)	58" (147cm)	Rear	17lb (7.7kgs)	
30094	Pro-1 Davit w/Anchor Point	22" (56cm)	72" (183cm)	Top	17lb (7.7kgs)	
30097	Pro-1 Mast Extension	-	30" (76cm)	-	9.3lb (4.2kgs)	
**Pro-1 Series Davits use "Tuff-Klik Structure Bracket #5" Pt#60140 for Device Mounting						

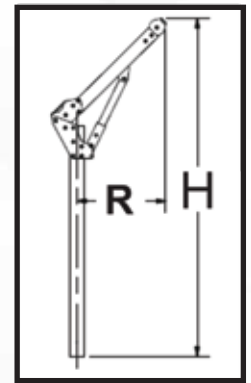

## Pro-2 Series Davits

The Pro-2 Series Davits are designed to be small and lightweight, while at the same time being strong, reliable, and providing economical packages. The Pro-2 Series Davits also FOLD UP for easy moving and storage.

**Other manufacturer brackets available. Please call us for more information.**

Part #	Model Description	Reach	Height	Winch/SRL Mount	Weight	Price
30055	Pro-2 Davit, 22R-74H(1 piece)	22" (56cm)	74" (188cm)	Rear	32lb (14.5kgs)	
30056	Pro-2 Davit, 22R-137H(2 piece)	22" (56cm)	137" (328cm)	Rear	56lb (25.4kgs)	
30116	Pro-2 Davit, 22R-97H(1 piece)	22" (56cm)	97" (247cm)	Rear	35lb (15.8kgs)	
30122	Anchor Point for Pro-2 Davits	-	-	-	1.4lb (0.7kgs)	
30174	Pro-2 Davit, 22R-117H(2 piece)	22" (56cm)	117" (297cm)	Rear	55lb (24.9kgs)	
** Pro-2 Series use "Tuff-Klik Structure Bracket #7" Pt#60142 for Device Mounting						

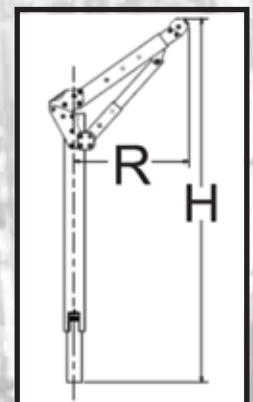

## Pro-3 Series Davits

Tuff Built Product's Pro-3 Series davits have a unique modular design that allows the davit to be light weight, yet high in strength. Designed with an integrated, easy to set fall brake system and the ability to mount mechanical devices front and rear, the Pro-3 Series davits provide the customer with peace of mind for years to come.

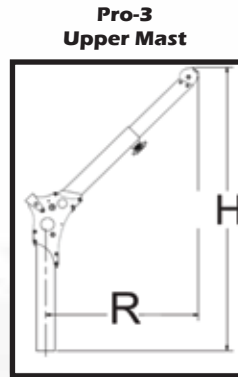

**Pro-3  
Upper Mast**  
PT# 30104  
PT# 30105

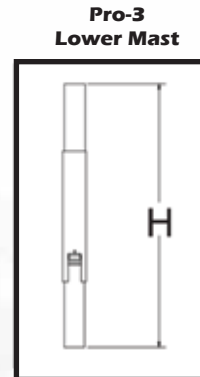

**Pro-3  
Lower Mast**  
PT# 30108  
PT# 30109

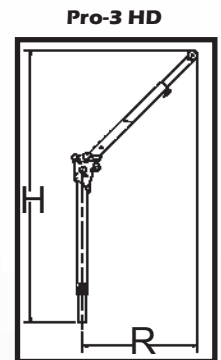

**Pro-3 HD**  
PT# 30231

**Other manufacturer brackets available. Please call us for more information.**

Part #	Model Description	Reach	Height	Winch/SRL Mount	Weight	Price
30104	Pro-3 Davit, 28R-54H Upper	19.50" (50cm)	46"(117cm) to 55.75"(142cm)	Rear/Front	21lb(9.5kgs)	
30105	Pro-3 Davit, 28R-66H Upper		58"(147cm) to 66.75"(170cm)	Rear/Front	25lb(11.4kgs)	
30106	Pro-3 Davit, 28R-84H	29.00" (74cm)	76.5"(194cm) to 85.5"(217cm)	Rear/Front	31lb(14.1kgs)	
30107	Pro-3 Davit, 28R-108H		99.75"(253cm) to 108.5"(275cm)	Rear/Front	32lb(14.5kgs)	
30108	Pro-3 Davit, 40" Lower Mast	-	40"(102cm)	-	12lb(5.4kgs)	
30109	Pro-3 Davit, 52" Lower Mast	-	52"(132cm)	-	16lb(7.3kgs)	
30231	Pro-3 HD Davit, 42R-100H	33" (84cm) 42" (107cm)	91"(231cm) to 100"(254cm)	Rear/Front	50lb(22.7kgs)	
30178	Anchor Point for Pro-3 Davits	-	-	-	0.45lb(0.20kgs)	
30175	Single Re-Direct Pulley	-	-	-	1.12lb(0.51kgs)	

**\*\*Pro-3 Standard Davits use "Tuff-Klik Structure Bracket #6" Pt#60141 for Device Mounting**

**\*\*Pro-3 HD Davits use "Tuff-Klik Structure Bracket #7" Pt#60142 for Device Mounting**



Tuff Built has specialized Pro-3 Hoist system packages, these are the best selling complete systems we recommend when looking for turnkey solutions.



### Standard Pro-3

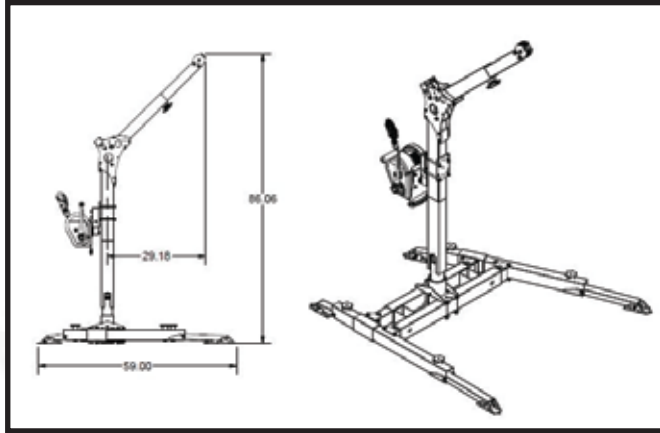

PT# 20035;  
Pro-3 Hoist System 28" Offset (Max)

### Heavy Duty Pro-3

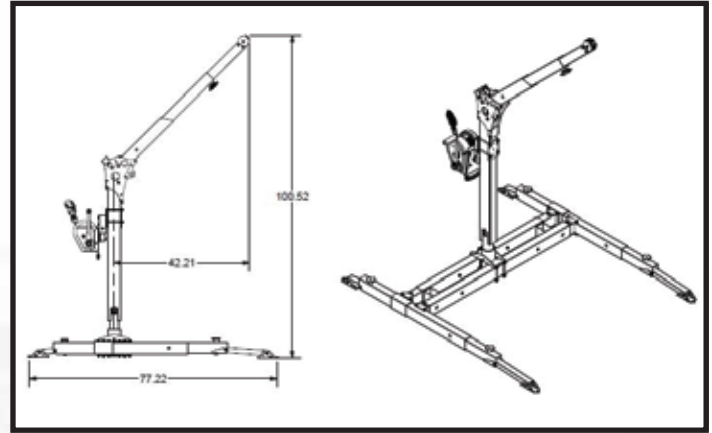

PT# 20080;  
Pro-3 HD Hoist System 42" Offset (Max)

Package Part#	Package Contains	Reach	Height	Upper Davit	Lower Mast	Base	Winch	Structure Bracket	Weight	Price
20035	Pro-3 Hoist System, Davit 28R-84H (Upper & Lower Mast) w/Portable Base (6pc), Winch & Winch Bracket	28" (71cm)	84" (213cm)	30104	30108	30070	60217	60141	129.0lbs (58.5kgs)	
20036	Pro-3 Hoist System, Davit 28R-84H (1pc Mast) w/Portable Base (5pc), Winch & Winch Bracket	28" (71cm)	84" (213cm)	30106	-	30070	60217	60141	129.0lbs (58.5kgs)	
20037	Pro-3 Hoist System, Davit 28R-108H (Upper & Lower Mast) w/Portable Base (6pc), Winch & Winch Bracket	28" (71cm)	108" (274cm)	30105	30109	30070	60217	60141	135.0lbs (61.3kgs)	
20038	Pro-3 Hoist System, Davit 28R-108H (1pc Mast) w/Portable Base (5pc), Winch & Winch Bracket	28" (71cm)	108" (274cm)	30107	-	30070	60217	60141	129.0lbs (58.5kgs)	
20080	Pro-3 HD Hoist System, Davit 42R-100H (1pc Mast) w/Portable Base (5pc), Winch & Winch Bracket	42" (107cm)	100" (254cm)	30231	-	30115	60217	60142	170.0lbs (77.1kgs)	
20092	Pro-3 Hoist System, Davit 28R-54H (Upper & Lower Mast) w/Portable Base (3pc)	28" (71cm)	84" (213cm)	30104	30108	30070	-	-	98.0lbs (44.5kgs)	
20113	Pro-3 Hoist System, Davit 28R-84H (Upper & Lower Mast) w/Portable Base (6pc)	28" (71cm)	84" (213cm)	30104	30108	30070	-	-	89.0lbs (40.5kgs)	
20136	Pro-3 HD Hoist System, Davit 42R-100H (1pc Mast) w/Portable Base (5pc)	42" (107cm)	100" (254cm)	30231	-	30115	-	-	130.0lbs (59kgs)	

## Analog Davits

**Tuff Built Products Analog Davits are designed for an ultimate strength of 5000 Lbs (22.2kN)**

Part #	Model Description	Reach	Height	Winch Mtg	Weight	Price
30095	Analog Series Davit, 48R- 168H	48"(122cm)	168"(427cm)	Anchor Point	93lbs(42.2kgs)	
50015	Analog Series Davit, 48R- 84H	48"(122cm)	168"(427cm)	Rear	105lbs(47.7kgs)	

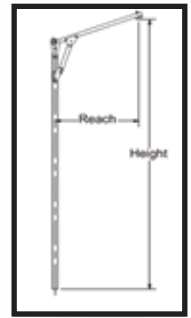

Tuff Built has a variety of Analog series davits available, call for more information.

## Pro-2 Series Bases



Part #	Model	Weight	Price
30071	Pro-2 Base, Hitch Mount	62 lbs(28.kgs)	
30072	Pro-2 Base, "Bridge Barrier"	65 lbs(29.5kgs)	
30073	Pro-2 Base, Counterweight System	118 lbs(53.5kgs)	
30093	Pro-2 Base, Hitch Mount (30" mast max.)	54 lbs(24.5kgs)	

## Permanent Bases

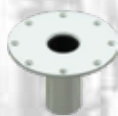

Finish	Core Mount	Flush Floor Mount (Existing Concrete)	Flush Floor Mount (Fresh Concrete)	Floor Mount	Deck Mount	Cap
CS-500 (Mild Steel)	30062	30021	30023	30031	30080	30019
Hot Dip Galvanized (Mild Steel)	30061	30018	30043	30048	30081	N/A
304 SS	30063	30022	30024	30030	30082	30069
316 SS	30064	30038	30039	30047	30083	30068

# Portable Bases

Tuff Built Products Pro-Series portable davit bases allow for set up and use at multiple locations with no need for permanent installations. Various designs are available, including free standing, counter weighted, clamp-on, or vehicle mounted systems.

## Pro-1 Forklift Basket

Pro-1 Forklift Basket is designed for working at height when secured to a forklift.

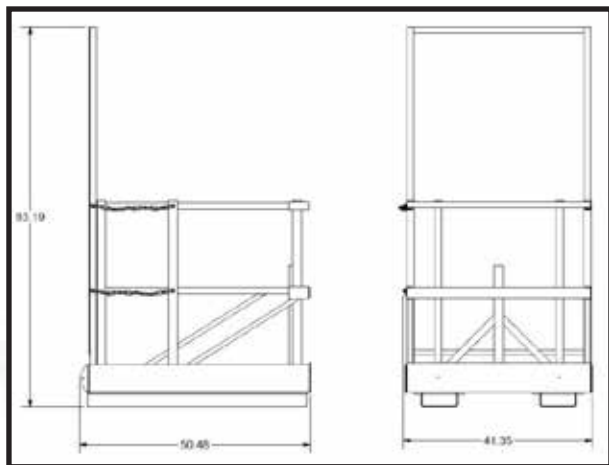

Part #	Model	Weight	Price
30164	Pro-1 Forklift Basket	29.5 lbs (13.4kgs)	

## Pro-1 Series Bases

Pro-1 Series Portable Bases are designed to be compact and lightweight. For use with Pro-1 Davits only.

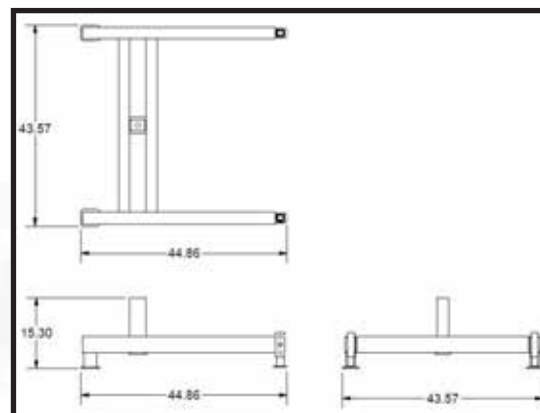

Part #	Model	Weight	Price
30067	Pro-1 Base, Portable	24 lbs (10.9kgs)	

## Pro-1 Guardrail Bases

Pro-1 Guardrail Bases have the option of a bar or chain entry gate, for use with any Pro-1 Davit.

Part #	Model	Weight	Price
30017	Pro-1 Guardrail w/Bar Gate	55 lbs (24.9kgs)	
30098	Pro-1 Guardrail w/Chain Gate	55 lbs (24.9kgs)	

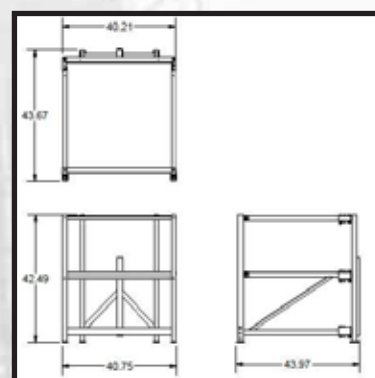

## Pro-2 Hitch Bases

Pro-2 Series Portable Bases are versatile and designed for rugged and demanding applications. This system MUST be attached to a vehicle when the system is in use. For use with any Pro-2 and Pro-3 Davits.

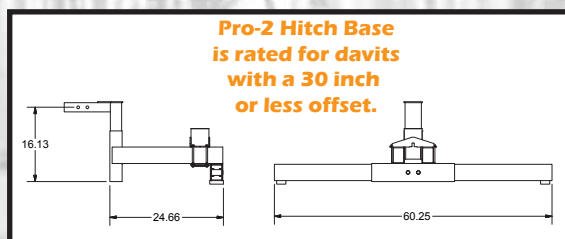

Part #	Model	Weight	Price
30093	Pro-2 Base, Hitch Mount	34 lbs (15.5kgs)	

## Pro-2 Heavy Duty Hitch Bases

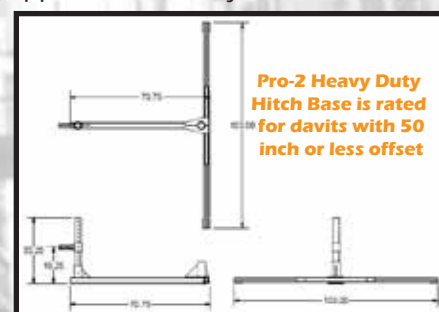

Part #	Model	Weight	Price
30336	Pro-2 Base, Heavy Duty Hitch Mount	155 lbs (70.5kgs)	

Specifications are subject to change without notice.



Pro-3 Counterweight Base System

The Pro-3 Counterweight Base has a common main center with a variety of anchoring and/or positioning options.

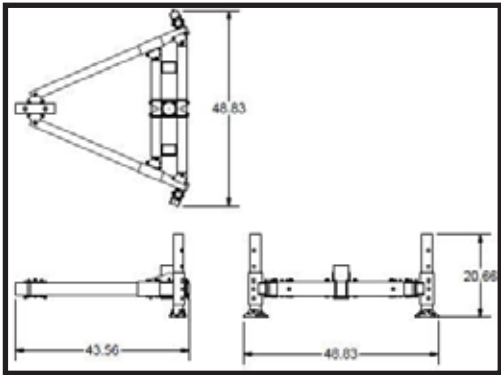

Part #	Model	Weight	Price
30071	Pro-3 Base	65 lbs (29.5kgs)	

Options include: Rail Clamp for anchoring to railway track rails, a wheeled weight cart and/or weight rack for counterbalanced applications, a hitch mount adapter that plugs into a vehicle tow receiver.

Extensions to make the system longer are available to position system as needed. Weights are NOT included. (25 lbs weights are recommended).

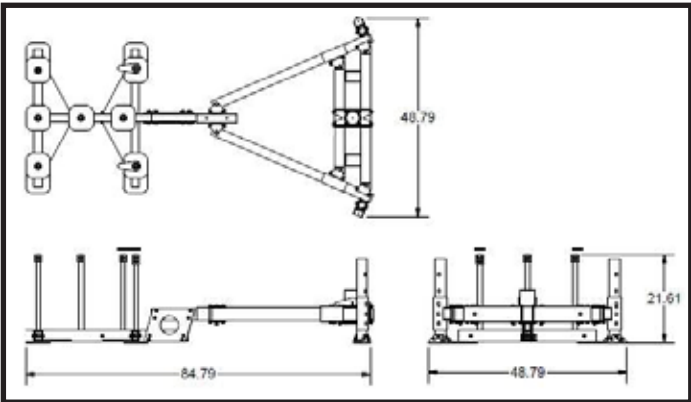

Part #	Model	Weight	Price
30073	Pro-3 Base, Counterweight	120 lbs (54.5kgs)	

Pro-3 Counterweight Base Attachments

PT# 30218 Counterweight Cart

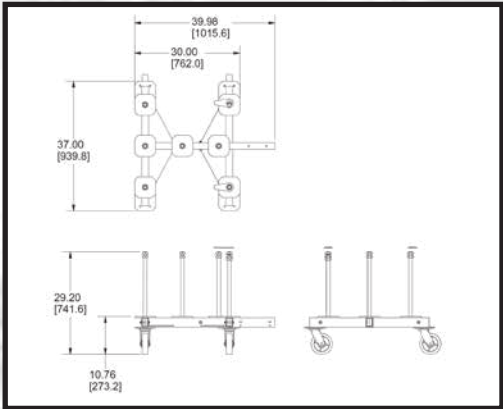

Part #	Model	Weight	Price
30218	Counterweight Cart	120 lbs (54.5kgs)	

PT# 30180 Counterweight Rack

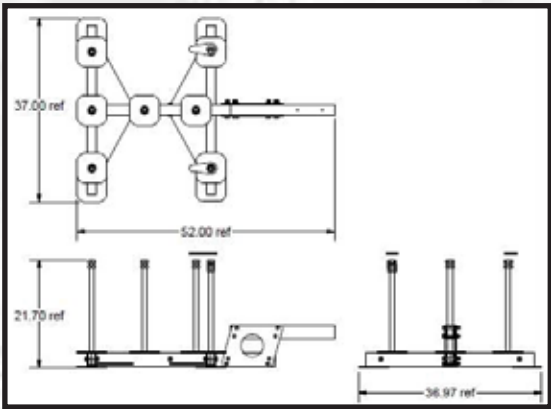

Part #	Model	Weight	Price
30180	Counterweight Rack	80lbs (36.3kgs)	

PT# 30328 Rail Clamp Adapter

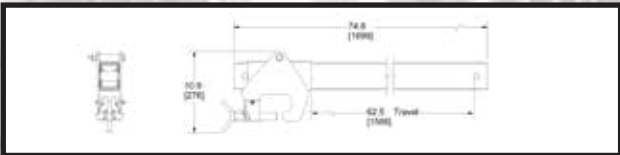

Part #	Model	Weight	Price
30491	Rail Clamp	28 lbs (12.7kgs)	

PT# 30354 Hitch Adapter



Part #	Model	Weight	Price
30354	Hitch Adapter	4 lbs (1.8kgs)	

## Pro-3 Bridge Barrier Accessories

The Bridge Barrier system is designed to provide fall protection for workers while on the side of a bridge. Bridge Barrier accessories allow for a secure counter-weight system while going over barriers, handrails, dividers and other partitions.



PT# 30420



PT# 30421

Part #	Model	Weight	Price
30420	Bridge Barrier Hitch Attachment	27.0 lbs (12.3kgs)	
30421	Bridge Barrier Vehicle Wheel Rack	63.0 lbs (28.6kgs)	

## Pro-3 Portable Base

The Pro-3 Portable Base has four (4) independent leveling legs and fits around hole sizes of 54" to 75" (Diameter).

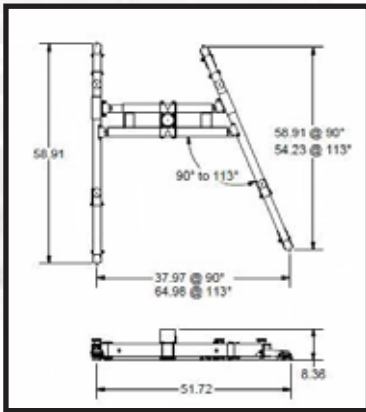

Part #	Model	Weight	Price
30070	Pro-3 Base, Portable	61 lbs (27.7kgs)	

## Pro-3 External Clamp-On Base

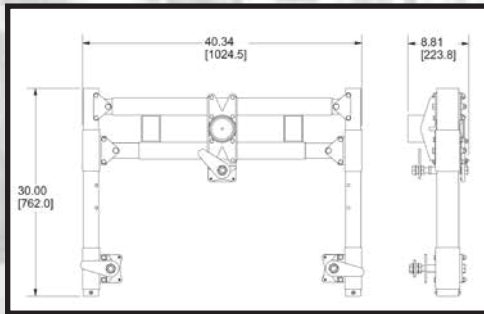

Part #	Model	Weight	Price
30189	Pro-3 Base, External Tank Collar	67 lbs (30.0kgs)	

## Pro-3 Bridge Barrier

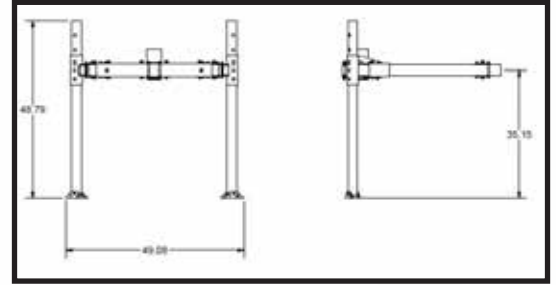

Part #	Model	Weight	Price
30072	Pro-3 Base, Bridge Barrier	72 lbs (32.7kgs)	

## Pro-3 Portable Heavy Duty Base

The Pro-3 Portable Heavy Duty Base fits around hole sizes of 58" to 136" (Diameter).

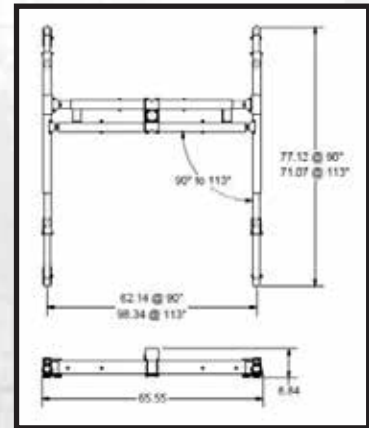

Part #	Model	Weight	Price
30115	Pro-3 Base, Portable Heavy Duty	86 lbs (39.1kgs)	

## Pro-3 Bolt-On Flange Base

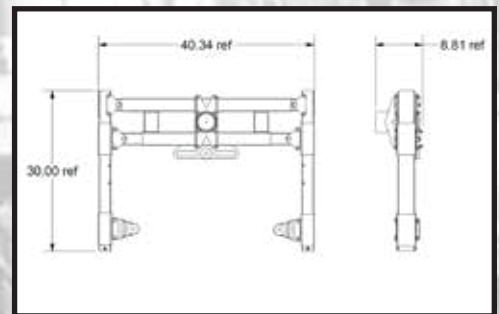

Part #	Model	Weight	Price
30181	Pro-3 Base, Bolt-On Flange	63 lbs (28.6kgs)	

Part #	Model	Finish	Weight	Price
30036	Barrel Mount Base Fixed (2.00" Throat) A= 0.19" to 2.00" (0.00mm to 50.8mm)	CS-500	43.0 lbs (19.4kgs)	
30045		304 SS	45.0 lbs (20.3kgs)	
30044		316 SS	45.0 lbs (20.3kgs)	
30161	Barrel Mount Base Fixed (5.00" Throat) A= 0.19" to 5.00" (0.00mm to 127.0mm)	CS-500	45.7 lbs (20.6kgs)	
30192		304 SS	47.7 lbs (21.5kgs)	
30193		316 SS	47.7 lbs (21.5kgs)	
30166	Barrel Mount Base Fixed (7.00" Throat) A= 0.19" to 7.13" (4.8mm to 181.0mm)	CS-500	47.5 lbs (21.4kgs)	
30195		304 SS	49.5 lbs (22.3kgs)	
30196		316 SS	49.5 lbs (22.3kgs)	

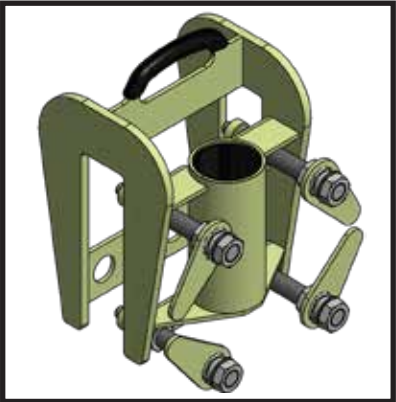
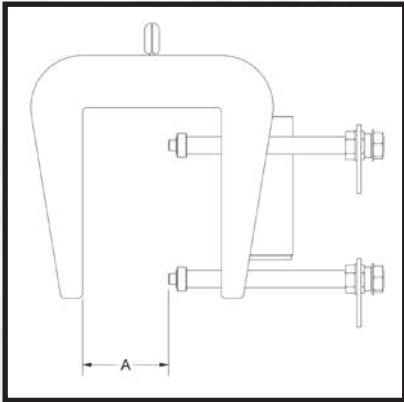

Adjustable Barrel Mount

Part #	Model	Finish	Weight	Price
30029	Barrel Mount Base, Adjustable A= 1.00" to 25.00" (0.00mm to 635.0mm)	CS-500	96.00 lbs(43.2kgs)	

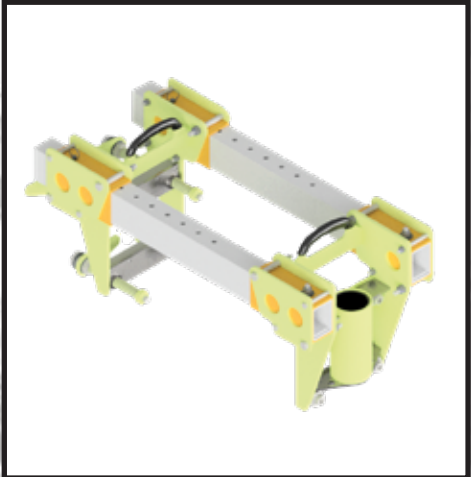
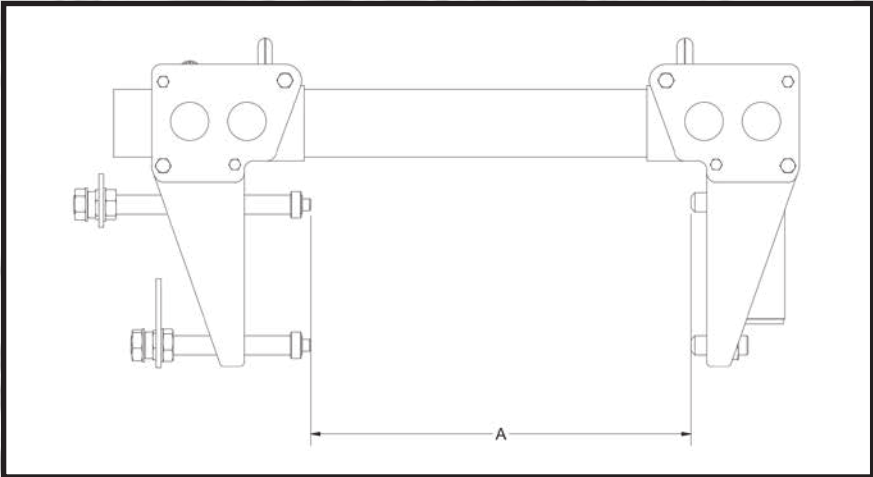



# Permanent Bases

Tuff Built's Pro-Series Permanent davit bases are designed for permanent installations at locations where repeated or frequent use is required. Permanent bases are available in a variety of designs, finishes, and materials to meet your specific requirements. Custom Permanent Bases can be designed to meet your specific application requirements. Please call us for more information.

## Flush Mount Floor Bases



Base Type	Material	Finish	Part #	Weight	Price
Base, Core Mount	Mild Steel	CS-500	30062	6.5lbs(2.9kgs)	
	Mild Steel	Hot Dip Galvanized	30061	6.5lbs(2.9kgs)	
	304 SS	Sandblasted	30063	7.8lbs(3.5kgs)	
	316 SS	Sandblasted	30064	7.8lbs(3.5kgs)	



Base Type	Material	Finish	Part #	Weight	Price
Base, Flush Mount (Existing Concrete)	Mild Steel	CS-500	30021	17.1lbs(7.8kgs)	
	Mild Steel	Hot Dip Galvanized	30018	17.1lbs(7.8kgs)	
	304 SS	Sandblasted	30022	18.7lbs(8.5kgs)	
	316 SS	Sandblasted	30038	18.7lbs(8.5kgs)	



Base Type	Material	Finish	Part #	Weight	Price
Base, Flush Floor Mount (Fresh Concrete)	Mild Steel	CS-500	30023	18.5lbs(8.4kgs)	
	Mild Steel	Hot Dip Galvanized	30043	18.5lbs(8.4kgs)	
	304 SS	Sandblasted	30024	20.1lbs(9.2kgs)	
	316 SS	Sandblasted	30039	20.1lbs(9.2kgs)	

## Wall Mount Bases



Base Type	Material	Finish	Part #	Weight	Price
Base, 3 Point Wall Mount	Mild Steel	CS-500	30037	9lbs(4.1kgs)	
	Mild Steel	Hot Dip Galvanized	30052	9lbs(4.1kgs)	
	304 SS	Sandblasted	30051	10.4lbs(4.8kgs)	
	316 SS	Sandblasted	30049	10.4lbs(4.8kgs)	



Base Type	Material	Finish	Part #	Weight	Price
Base, 4 Point Wall Mount	Mild Steel	CS-500	30032	10.3lbs(4.7kgs)	
	Mild Steel	Hot Dip Galvanized	30054	10.3lbs(4.7kgs)	
	304 SS	Sandblasted	30033	11.9lbs(5.4kgs)	
	316 SS	Sandblasted	30053	11.9lbs(5.4kgs)	

Specifications are subject to change without notice.

## Corner Mount Bases

Base Type	Material	Finish	Part #	Weight	Price
Base, Corner Mount 8" (Concrete Mount)	Mild Steel	CS-500	30350	32.3lbs(14.7kgs)	
	Mild Steel	Hot Dip Galvanized	30351	32.3lbs(14.7kgs)	
	304 SS	Sandblasted	30352	34.6lbs(15.8kgs)	
	316 SS	Sandblasted	30353	34.6lbs(15.8kgs)	



Base Type	Material	Finish	Part #	Weight	Price
Base, Corner Mount 8" (Steel Mount)	Mild Steel	CS-500	30246	11.8lbs(5.3kgs)	
	Mild Steel	Hot Dip Galvanized	30257	11.8lbs(5.3kgs)	
	304 SS	Sandblasted	30258	13.8lbs(6.2kgs)	
	316 SS	Sandblasted	30259	13.8lbs(6.2kgs)	



## Deck Mount Bases

Base Type	Material	Finish	Part #	Weight	Price
Base, Deck Mount	Mild Steel	CS-500	30080	24.3lbs(10.9kgs)	
	Mild Steel	Hot Dip Galvanized	30081	24.3lbs(10.9kgs)	
	304 SS	Sandblasted	30082	26.0lbs(11.7kgs)	
	316 SS	Sandblasted	30083	26.0lbs(11.7kgs)	



## Floor Mount Bases

Base Type	Material	Finish	Part #	Weight	Price
Base, Floor Mount	Mild Steel	CS-500	30031	19.8lbs(8.9kgs)	
	Mild Steel	Hot Dip Galvanized	30048	19.8lbs(8.9kgs)	
	304 SS	Sandblasted	30030	21.8lbs(9.9kgs)	
	316 SS	Sandblasted	30047	21.8lbs(9.9kgs)	



## Sleeve Caps

Base Type	Material	Finish	Part #	Weight	Price
Cap, Base	Mild Steel	CS-500	30019	1.11lbs(.51kgs)	
	304 SS	Sandblasted	30069	1.13lbs(.52kgs)	
	316 SS	Sandblasted	30068	1.13lbs(.52kgs)	



# Pole Hoist and Horizontal Entry Systems

## Pole Hoists & Accessories

Tuff Built "Pole Hoists" allow for vertical or horizontal confined space entry-retrieval, rescue, as well as fall protection and work positioning. The Pole Hoist uses a single anchor point near the work area while the attendant remains safely back from any hazard. "Pro-Series Pole Hoists" feature "Tuff-Klik" pin-less adjustment, which eliminates lost or damaged locking pins.

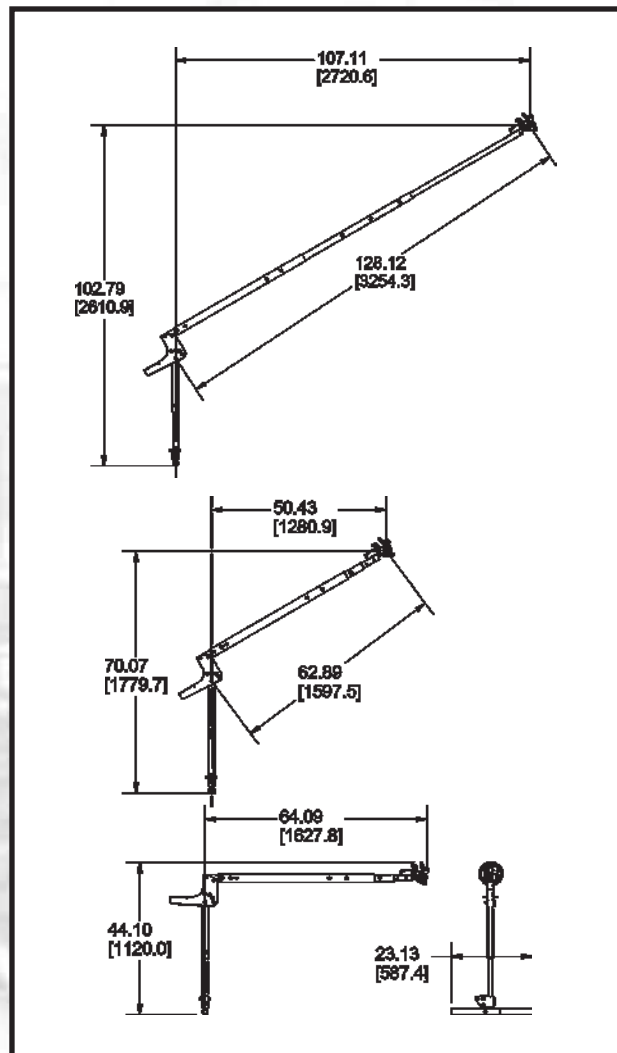
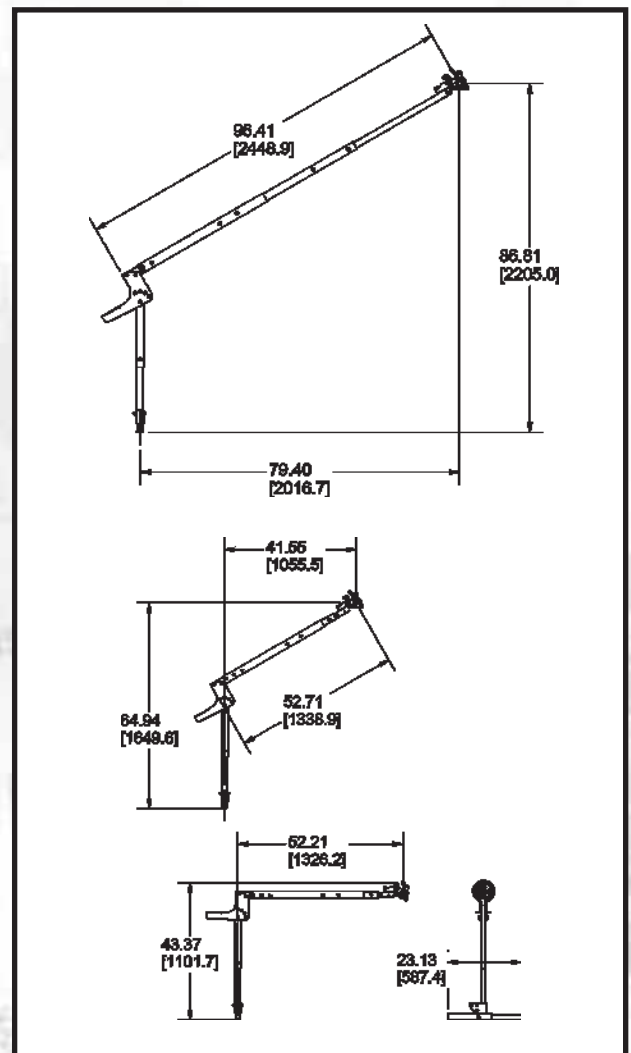
**Pro-1 Pole Hoist**
**Pt#: 30040**

**Pro-2 Pole Hoist**
**Pt#: 30041**

Part #	Package Contains	Pole Hoist	Winch PT #	Bracket PT #	Price
20041	Pkg Pro-1 Pole Hoist w/Winch & Winch Bracket	30041	60217	60162	
20042	Pkg Pro-2 Pole Hoist w/Winch & Winch Bracket	30040	60217	60162	

**Other manufacturer brackets available. Please call us for more information.**

Specifications are subject to change without notice.

Tuff Built's Horizontal Entry System is designed for confined space entry/retrieval and rescue operations involving horizontal entries with vertical positioning or retrieval required inside the space.

The Horizontal Entry System may be used with a Clamp-On or Bolt-On Tank Collar Base for adaption to different man holes. The External Clamp-On Base with Mast (30321) can be assembled for left and right entry requirements.

Part #	Description	Weight	Price
20073	Package, Horizontal Entry System (30235, 30321, 60217)	151.0Lbs(68.6kgs)	
20074	Package, Horizontal Entry System (30235, 30080, 30234)	87.0Lbs(39.5kgs)	
30234	Support Mast, 72" (1829mm)	27.5Lbs(12.5kgs)	
30235	Horizontal Entry Arm	37.0Lbs(16.8kgs)	
30276	Base, Bolt-On Horizontal Entry w/Mast (30303)	71.0Lbs(32.3kgs)	
30303	Support Mast, 19.50" (495.3mm)	7.4Lbs(3.4kgs)	
30321	Base, Clamp-On Horizontal Entry w/Mast (30303)	80.0Lbs(36.4kgs)	
60211	Bracket, SRL w/Retrieval Capability Mount	4.0Lbs(1.8kgs)	
60212	Bracket, Pro-2/Pro-3 Winch Mount for Horizontal Entry	5.4Lbs(2.5kgs)	

**Other manufacturer brackets available. Please call us for more information.**

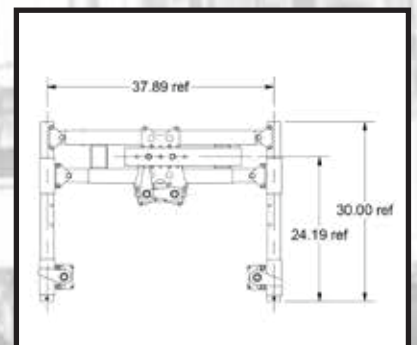
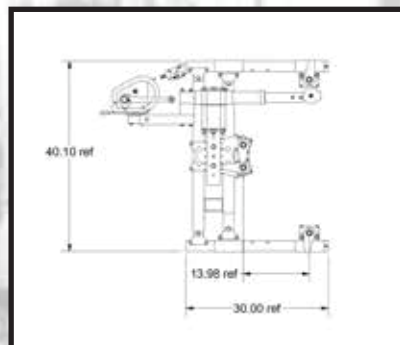
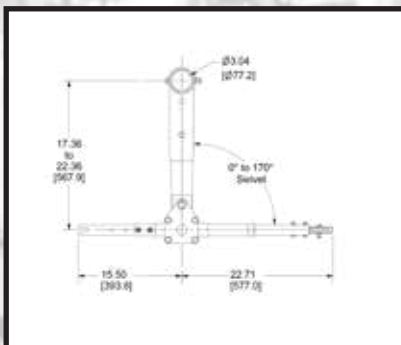
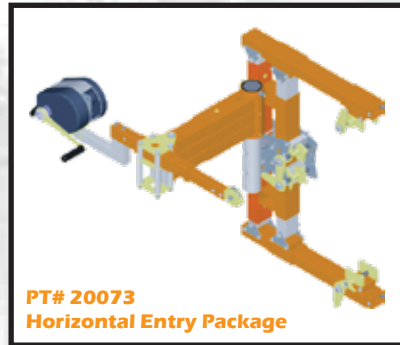



# Beam Clamps and Anchor Points

## Anchor Points

Tuff Built Products offers a variety of products designed to place anchor points where they are needed to support fall arrest, entry retrieval, rescue, and work positioning systems.

Part #	Description	Weight	Price
60243	Tie -Off Rings (Bolt On) 5/8 x 1.00 (Mild Steel CS-500)	0.30 lbs (0.14 kgs)	
60244	Tie -Off Rings (Bolt On) 1/2 x 1.00 (Mild Steel CS-500)	0.30 lbs (0.14 kgs)	
60245	Tie -Off Rings (Bolt On) 3/8 x 1.00 (Mild Steel CS-500)	0.30 lbs (0.14 kgs)	
60048	Brace, Pro-1 Door/Window 22" to 43" (56cm to 110cm)	13.0 lbs (5.9 kgs)	
60049	Anchor Point, Bolt on D-Ring (Mild Steel CS-500)	0.88 lbs (0.40 kgs)	
60161	Anchor Point, Bolt on D-Ring (Mild Steel CS-500)	3.5 lbs (1.6 kgs)	
60025	Anchor Point, Bolt on D-Ring (Mild Steel CS-500)	2.3 lbs (1.0 kgs)	
60292	Anchor Point, Bolt on D-Ring (304 SS)	0.7 lbs (0.31 kgs)	

**Custom designs are available. Call for more information.**

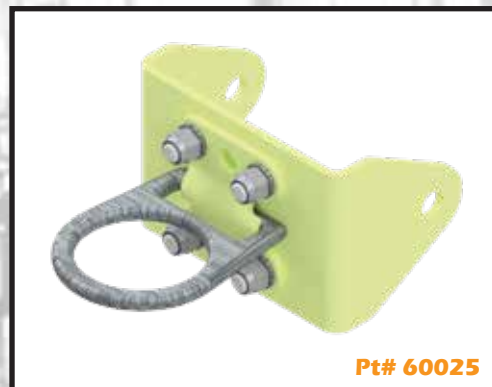
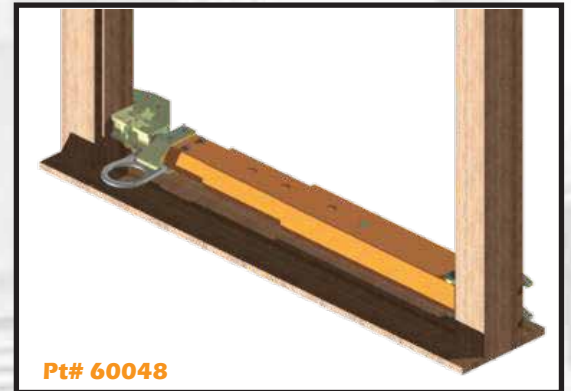
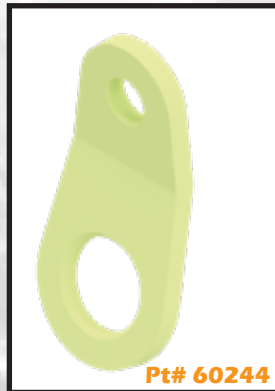
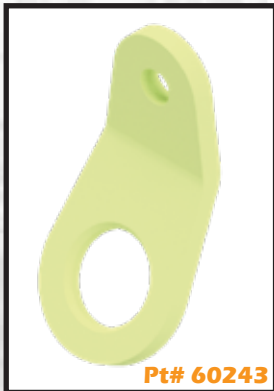

## Beam Clamps

Part #	Description	Weight	Price
30165	Sleeve, CS-500 ("I" Beam Clamp on Sleeve) 7" to 14"	65 lbs (29.5 kgs)	
60037	Anchor, Pro-1 - "I" Beam Clamp 5" to 14" (127mm to 356mm)	6 lbs (2.7 kgs)	
60038	Anchor, Pro-2 - "I" Beam Clamp 5" to 30" (127mm to 762mm)	8 lbs (3.6 kgs)	
60039	Anchor, Pro-1 - "I" Beam Slider 5" to 14" (127mm to 356mm)	6 lbs (2.7 kgs)	

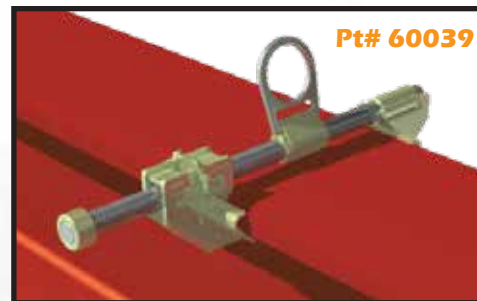
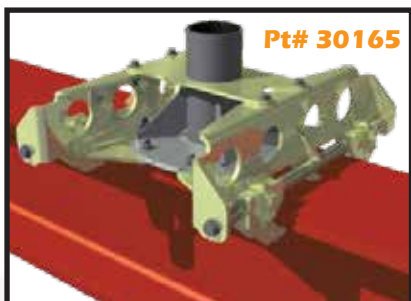

## Chair, Work Positioning

Part #	Weight	Price
40004	7.1lbs (3.2 kgs)	



## Custom Designs

Custom designs to fit your requirements are available. Please call for more information.



Pt# 30241  
Flange Clamp Anchor Point



Pt# 60293  
Parapet Fall Arrest Anchor Point

## Mobile Stair Systems with Fall Protection

Tuff Built's Products Mobile Access Stair Systems (M.A.S.S.) provide a portable means of accessing elevated work areas with a fully functional stairway versus a conventional ladder. The Mobile Access Stair System (M.A.S.S.) offers a wide variety of optional railing, cages, and anchor structures to provide ground-up fall protection for your elevated work activities. With the Free Standing Access Stair Systems (F.S.A.S.S.) which are height adjustable from 141" to 216" (to the entrance platform), the stairway design creates safer access to elevated work areas while carrying tools, and the anchor points adjust with the entrance platform.

## Freestanding Access Stair Systems (F.S.A.S.S.)

Part #	Model	Height	Wheels	Weight	Price
70110	F.S.A.S.S., 141/216H-2A-RM	114"(290cm)- 180" (457cm)	Rubber Molden	1920 lbs (873 kgs)	
70111	F.S.A.S.S., 129/215H-2A-U	86" (218cm)- 123" (312cm)	Urethane	1510 lbs (687 kgs)	
70112	F.S.A.S.S., 119/184H-2A-RM	114"(290cm)- 180" (457cm)	Rubber Molden	1850 lbs (841 kgs)	
70442	F.S.A.S.S., 171/293H-2A-MR-TH-HYD Manual Hydraulic Adjustment w/ umbrella	86" (218cm)- 123" (312cm)	Rubber Molden	3120 lbs (1418 kgs)	
70443	F.S.A.S.S., 141/218H-2A-MR-TH w/ umbrella	114"(290cm)- 180" (457cm)	Rubber Molden	2010 lbs (914 kgs)	

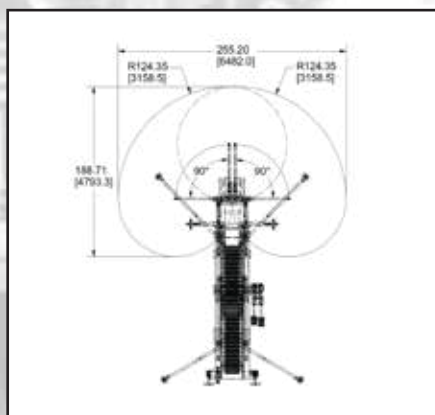
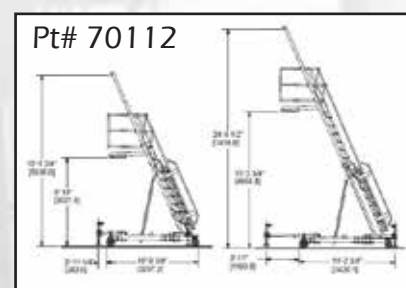
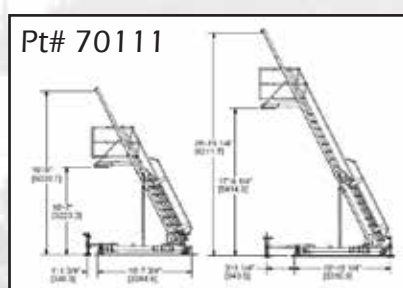
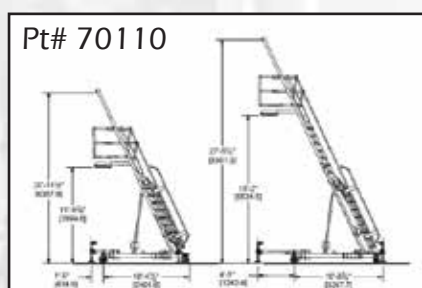

### Hydraulic options:

- Manual option
- Electric 110 V
- Electric 12 V
- Air/Hydraulic

Specifications are subject to change without notice.



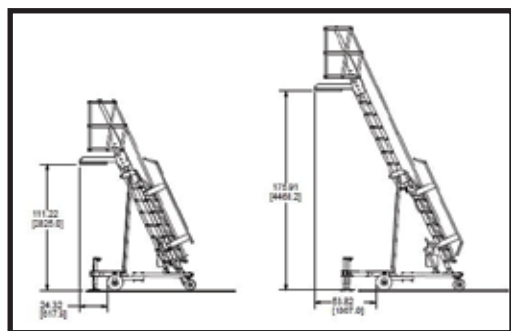

**PT# 70075**

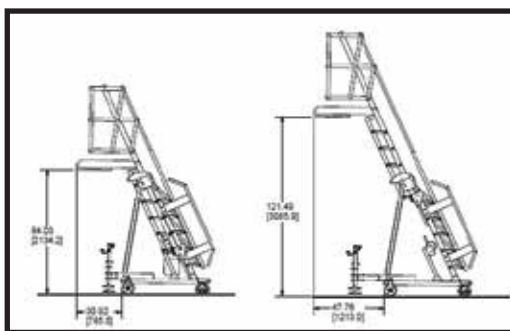

**PT# 70076**



Part #	Model	Height	Wheels	Weight	Price
70075	Mobile Access Stair System	114"(290cm)- 180" (457cm)	Rubber Molden	1225 lbs (557 kgs)	
70076	Mobile Access Stair System	86" (218cm)- 123" (312cm)	Urethane	1000 lbs (455 kgs)	

## Accessories for 70075 and 70076:

Part #	Model	Weight	Price
20009	Pkg, Rescue TRIPOD w/ Winch (Cage not included)	148 lbs (67 kgs)	
20014	Pkg, Davits(2) w/ Anchor points(2)	136 lbs (62 kgs)	
20015	Pkg, Rail 10ft w/ Anchor Point(2x)	193lbs (88 kgs)	
20039	Pkg, Cage 72" dia (Round)	60 lbs (27kgs)	
20134	Pkg, Cage 60" x 156" (Rectangular)	415lbs (189 kgs)	



**PT# 20134;  
MASS, Rectangle Cage**



**PT# 20039;  
MASS, Guardrail Cage**



**PT# 20014;  
MASS, Davit Anchor  
Points Pkg**



**PT# 20009;  
MASS, Tripod Pkg**



**PT# 20015;  
Traveling Rail**





# A-Frames and Quad Frames

## A- Frames

The A-Frame allows you to place overhead anchor points where you need them in your work place. The A-Frame systems roll over equipment/structures requiring access to provide ground-up fall protection for your elevated work activities.

Part #	Model	W	H	OH	L	OW	Wheels	Price
70777	A-Frame, 19W-23H-1R-1A-RM	234"	275"	285"	196"	250"	Rubber Molden	
70778	A-Frame, 17W-20H-2R-2A-RM	206"	312" to 239"	324" to 251"	196"	230"	Rubber Molden	
70787	A-Frame, 20W-23H-2R-2A-RM	240"	276"	286"	196"	263"	Rubber Molden	

**Please call for other dimensions.**

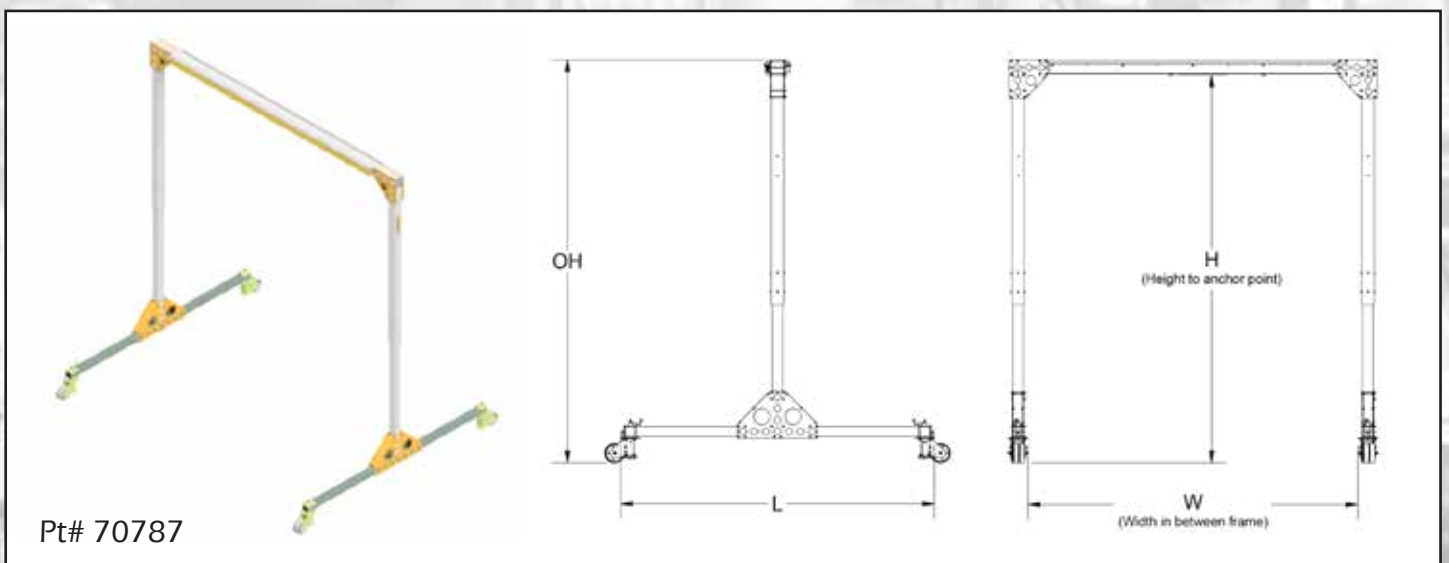
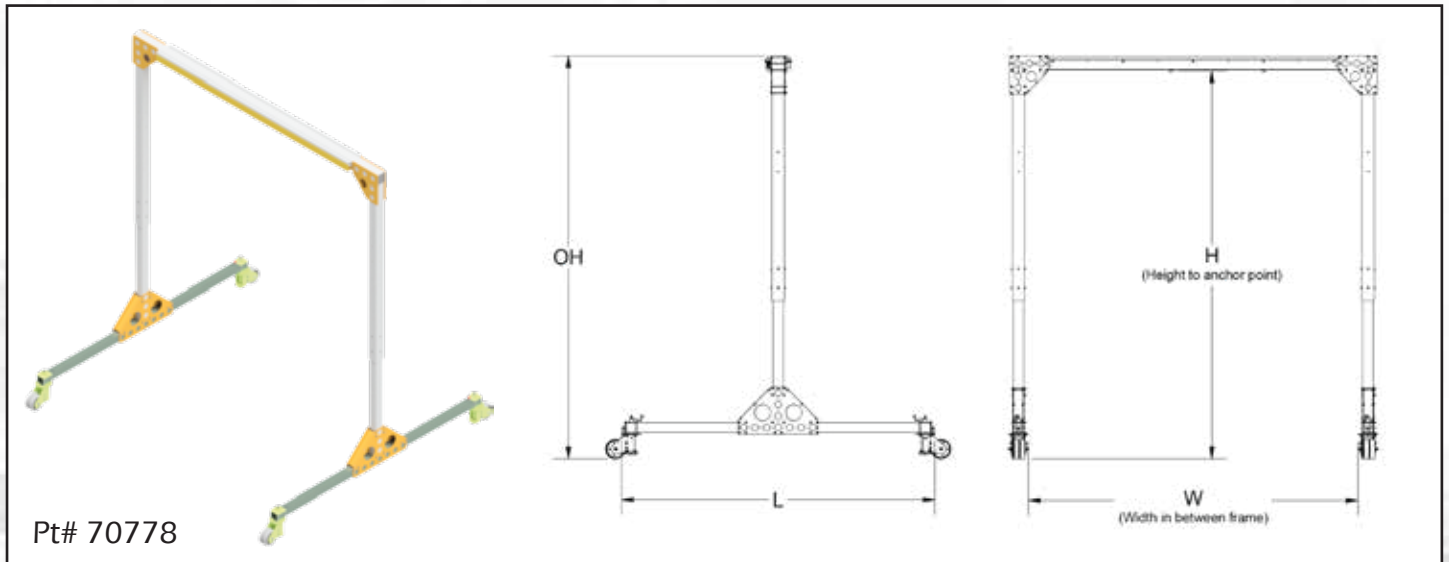

## Quad Frames

The Quad Frames allow you to place overhead anchor points where you need them. Quad Frame systems roll over equipment/ structures requiring access providing ground up fall protection for your elevated work activities.

Part #	Model	W	H	OH	L	OW	Wheels	Price
70631	Quad-Frame, 13W-19L-14H-2R-2A-RM	134"	167"	158"	241"	136"	Rubber Molden	
70763	Quad-Frame, 13W-27L-14H-2R-2A-RM	134"	158"	168"	345"	157"	Rubber Molden	
70779	Quad-Frame, 19W-27L-20H-2R-2A-RM	206"	312" to 239	328" to 255	341"	230"	Rubber Molden	

**Please call for other dimensions.**

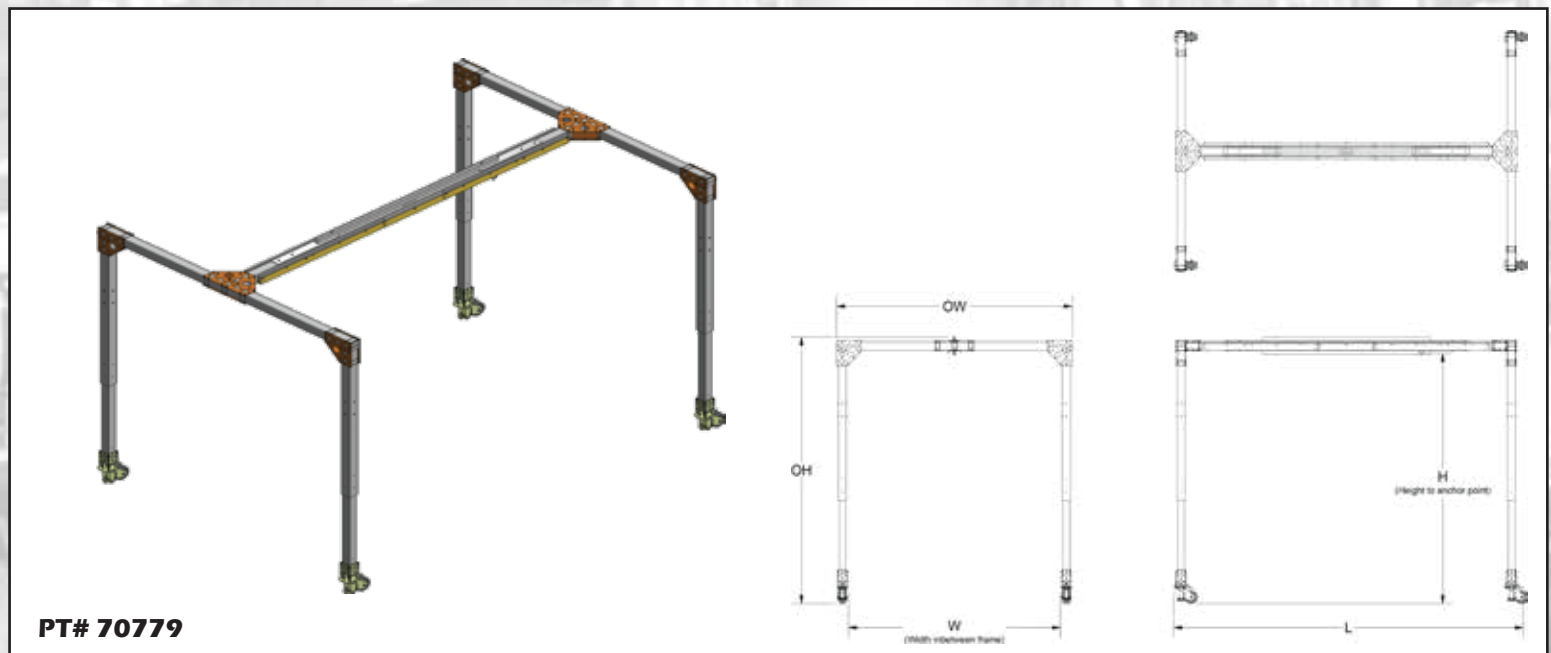
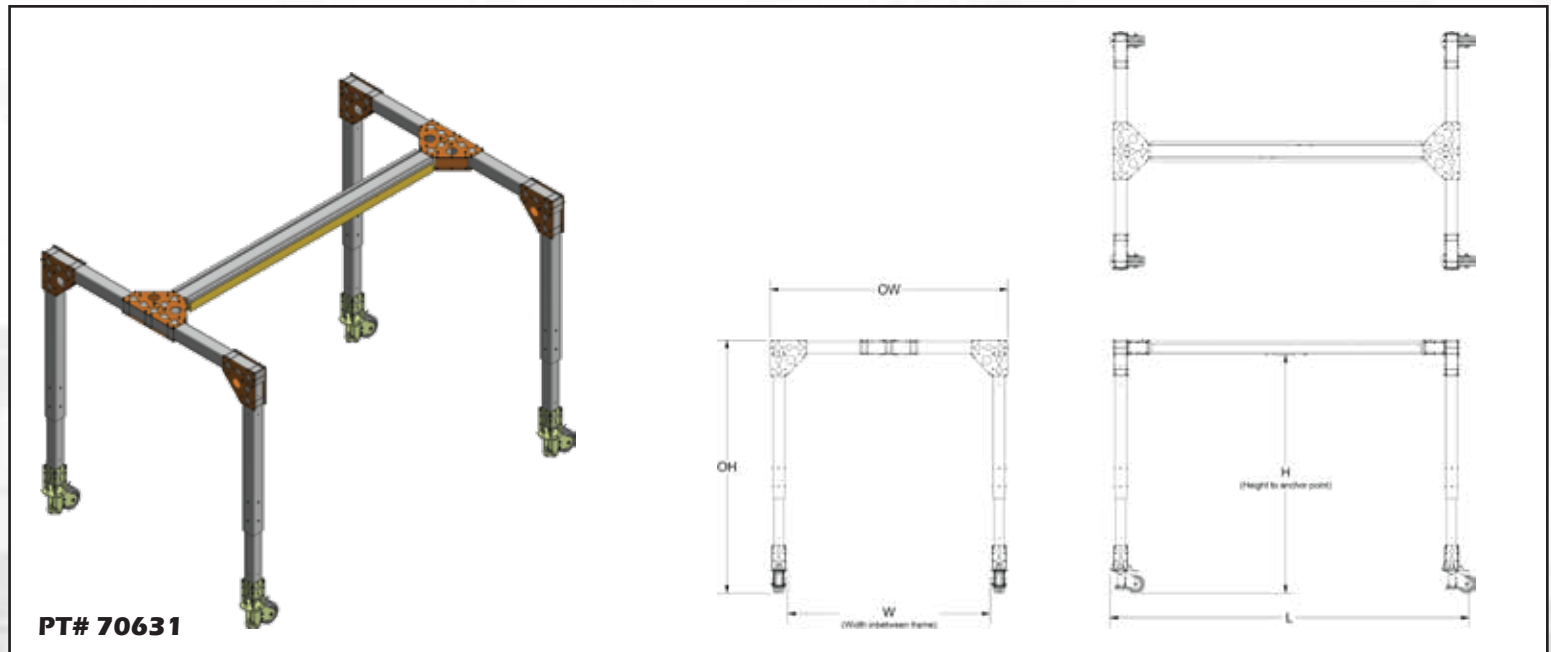

# Mobile Horizontal Rail Systems

Mobile Horizontal Rail Systems roll up to elevated work surfaces and provide mobile anchor points for fall protection along the length of an elevated area.



Mobile Horizontal Rail Systems may be fixed or adjustable in height. In addition, an access stair system with entrance platform can be incorporated to provide ground-up fall protection for your elevated work activities.

## Pro-3 Series Fixed Height Mobile Horizontal Rail

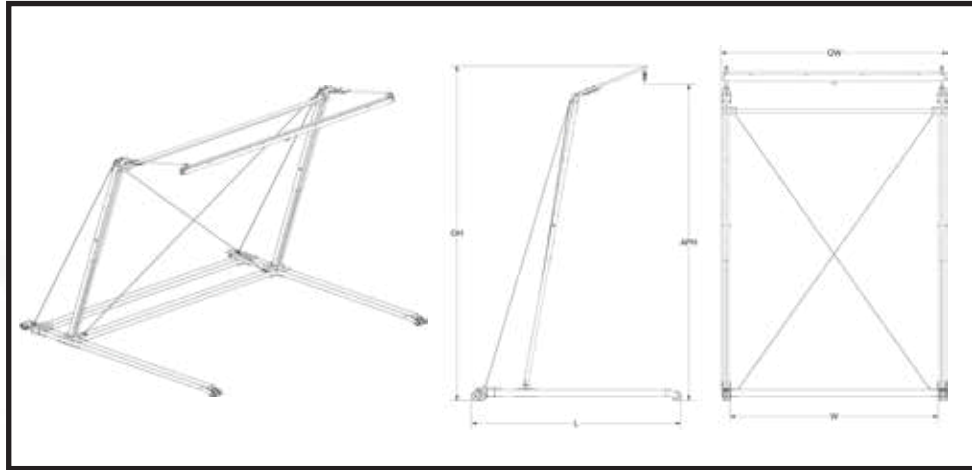

Part #	Model	W (width Inside)	APH (Anchor Point Height)	OH (Overall Height)	L (Length)	OW (Overall Width)	# of Rails	# of Anchors	Wheels	Weight	Price
70033	SXS Pro-3, 9W-25H-1R-2A-RM	9'-0"	25'-5"	26'-9 1/2"	16'-1 1/2"	10'-6"	1	2	Rubber Molden	1975lbs/ 898kgs	
50090	SXS Pro-3, 15W-20H-1R-2A-RM	15'-0"	20'-1"	21'-3 3/4"	16'-0"	16'-6"	1	2	Rubber Molden	2015lbs/ 916kgs	
70382	SXS Pro-3, 20W-19H-1R-2A-U	20'-0"	19'-0"	21'-8"	17'-9 1/2"	21'-3"	1	2	Urethane	1700lbs/ 773kgs	

## Pro-4 Series Fixed Height Mobile Horizontal Rail with Access

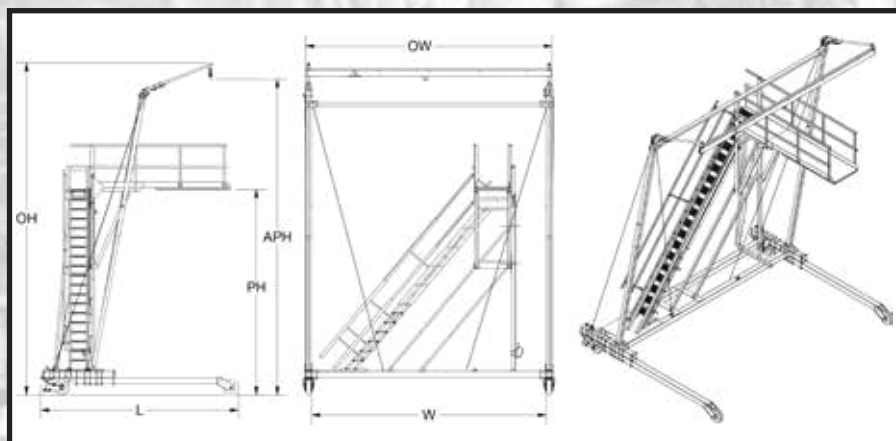

Part #	Model	W (width Inside)	APH (Anchor Point Height)	OH (Overall Height)	L (Length)	OW (Overall Width)	PH (Platform Height)	# of Rails	# of Anchors	Wheels	Weight	Price
70103	SXS Pro-4, 20W-25H-1R-1A-RM	19'-0"	25'-7"	26'-11"	16'-1 1/2"	20'-6"	9'-0" to 16'-8"	1	1	Rubber Molden	3050lbs/ 1387kgs	

Specifications are subject to change without notice.

## Pro-5 Series Adjustable Mobile Horizontal Rail System

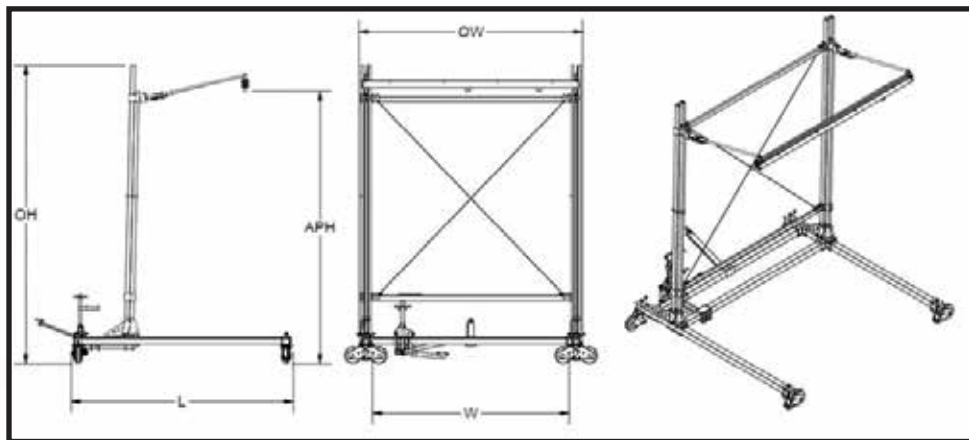

Part #	Model	W (width Inside)	APH (Anchor Point Height)	OH (Overall Height)	L (Length)	OW (Overall Width)	# of Rails	# of Anchors	Wheels	Weight	Hydraulic Controls	Price
50007	SXS Pro-5, 10W-12/18H-1R-1A-RM	9'-6"	12'-4" to 18'-6"	13'-8" to 19'-10"	14'-10"	12'-0"	1	1	Rubber Molden	2320lbs/ 1055kgs	Manual	
50040	SXS Pro-5, 15W-20/34H-2R-2A-RM	15'-0"	20'-0" to 33'-9"	21'-11" to 35'-9"	16'-5"	16'-6"	2	2	Rubber Molden	3525lbs/ 1602kgs	Manual	
70381	SXS Pro-5, 20W-19/33H-1R-2A-U	20'-0"	18'-9 1/2" to 32'-11"	20'-8" to 34'-9"	17'-10"	21'-3"	1	2	Urethane	3000lbs/ 1364kgs	Manual	

## Pro-6 Series Adjustable Mobile Horizontal Rail With Access

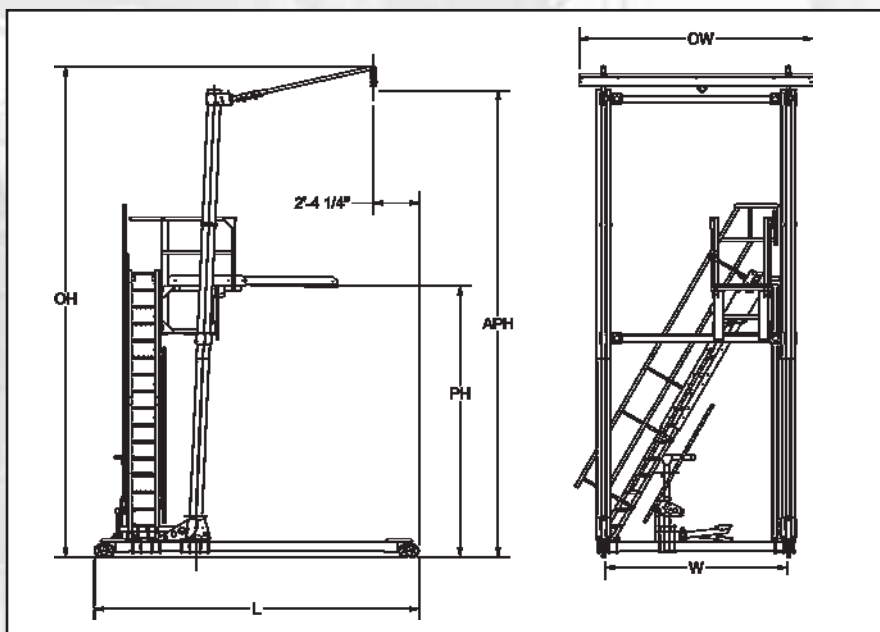

Part #	Model	W (width Inside)	APH (Anchor Point Height)	OH (Overall Height)	L (Length)	OW (Overall Width)	PH (Platform Height)	# of Rails	# of Anchors	Wheels	Weight	Hydraulic Controls	Price
50025	SXS Pro-6, 10W-19/24H-1R-1A-U	9'-0"	18'-5" to 24'-0"	19'-9" to 25'-3"	16'-8"	12'-0"	8'-9" to 13'-10"	1	1	Urethane	2720lbs/ 1236kgs	Manual	



# Portable Anchor Points & Restricted Space Davit Systems

Category

12

## Sky-X-Stand Mobile Anchor Points

Sky-X-Stand systems provide Mobile overhead fall protection anchor points in a lightweight and easy to set up package.



### The Sky-X-Stand series consist of:

- Pro-1 Single Anchor Points (fixed height)
- Pro-2 Double Anchor Point Truck Mount (fixed height)
- Pro-3 Mobile Anchor Point or Horizontal Rail (Single or Double Anchor Points, fixed height)
- Pro-4 Mobile Horizontal Rail (fixed height) with Access Platform (adjustable)
- Pro-5 Mobile Horizontal Rail (hydraulically adjustable height)
- Pro-6 Mobile Horizontal Rail (hydraulically adjustable height) with Access Platform (adjustable)
- Pro-7 Anchor Point Hitch Mount (Single or Double Anchor Points, fixed height)
- Pro-8 Restricted Space Anchor Point or Horizontal Rail (fixed height)
- Pro-9 Cube Systems and accessories

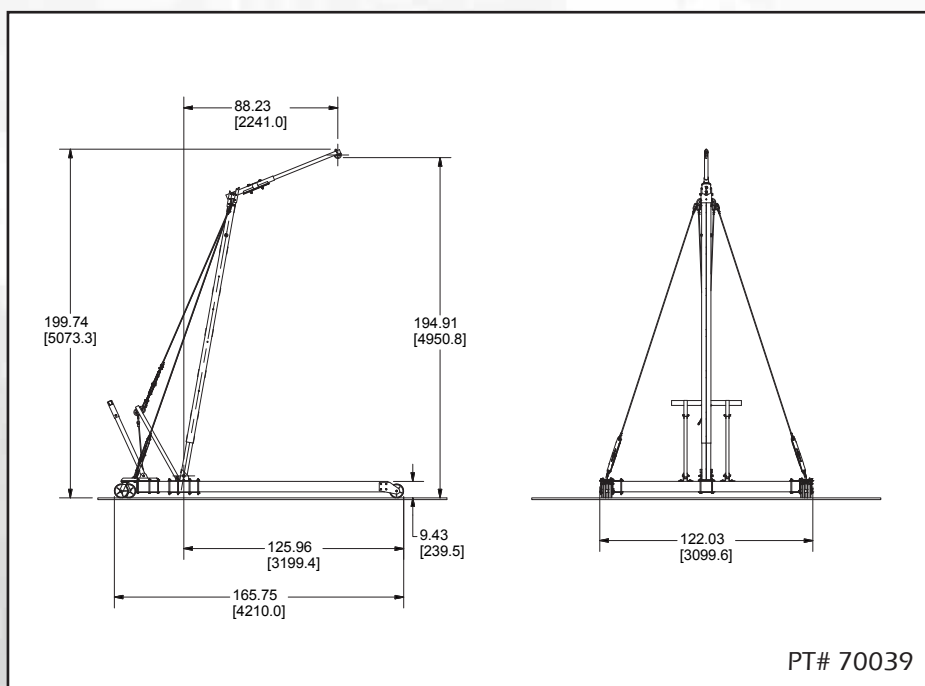

Part #	Model	W (width Inside)	APH (Anchor Point Height)	OH (Overall Height)	L (Length)	OW (Overall Width)	# of Anchors	Wheels	Weight	Price
70039	SXS Pro-3, 9W-16H-1A-U	9'-0"	16'-3"	16'-7 1/2"	13'-9 3/4"	10'-2"	1	Urethane	1000bs/ 500kgs	
70035	SXS Pro-3, 9W-18H-1A-U	9'-0"	18'-2"	18'-7"	13'-9 3/4"	10'-2"	1	Urethane	1000bs/ 500kgs	
70040	SXS Pro-3, 9W-20H-1A-U	9'-0"	19'-9"	20'-1"	13'-9 3/4"	10'-2"	1	Urethane	1000bs/ 500kgs	
70041	SXS Pro-3, 9W-22H-1A-U	9'-0"	21'-11 3/4"	22'-4 1/2"	13'-9 3/4"	10'-2"	1	Urethane	1000bs/ 500kgs	
70031	SXS Pro-3, 9W-24H-1A-U	9'-0"	23'-8 1/4"	24'-1"	13'-9 3/4"	10'-2"	1	Urethane	1000bs/ 500kgs	

## Sky-X-Stand Mobile Anchor Points

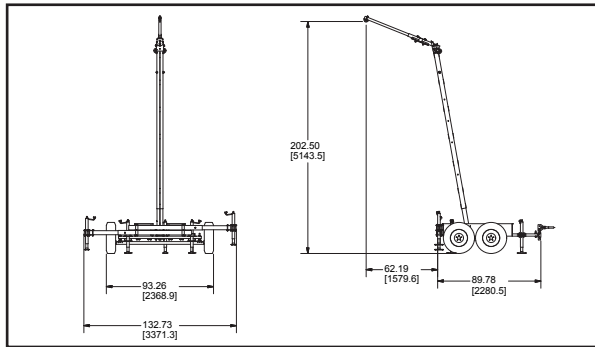

PRO-7 Sky-X-Stand systems are a counter weighted (steel bins must be filled with concrete) hitch mounted (units must be attached to vehicles during use) anchor point.

### Single Anchor Point Fixed Height

Part #	Nominal System Anchor Height	Nominal System Offset	Min. Height of Anchor above work surface	Diameter of working zone without outrigger kit	Diameter of working zone with outrigger kit	Weight (lbs/kgs)	Price
70179	16'- 0" (4.06m)	62.00" (1.57m)	7'- 0" (2.13m)	5'- 0" (1.5m)	10'- 0" (3.0m)	1600 / 728	
70027	18'- 0" (4.57m)	66.18" (1.68m)				1600 / 739	
70026*	20'- 0" (5.08m)	70.38" (1.78m)		N/A		1600 / 750	
70025*	22'- 0" (5.59m)	74.62" (1.89m)				1600 / 762	
70021 *	24'- 0" (6.09m)	78.88" (2.00m)				1600 / 773	

### Double Anchor Point Fixed Height

Part #	Nominal System Anchor Height	Nominal System Offset	Min. Height of Anchor above work surface	Diameter of working zone without outrigger kit	Diameter of working zone with outrigger kit	Weight (lbs/kgs)	Price
70340	16'- 0" (4.06m)	62.00" (1.57m)	7'- 0" (2.13m)	5'- 0" (1.5m)	10'- 0" (3.0m)	1775 / 807	
70339	18'- 0" (4.57m)	66.18" (1.68m)				1800 / 818	
70338*	20'- 0" (5.08m)	70.38" (1.78m)		N/A		1825 / 830	
70337*	22'- 0" (5.59m)	74.62" (1.89m)				1850 / 841	
70095*	24'- 0" (6.09m)	78.88" (2.00m)				1875 / 852	

## Restricted Space Davit Systems

The PRO-8 Restricted Space Series allows you to place fall protection anchors where you need them with minimal disruption to work place layouts and operations. Free standing portable and permanently installed options let you pick the solution that is best suited to your facility's individual needs. PRO-8 Series Rail Restricted Space Rail Systems can be customized in a variety of ways, such as height, length, position and number of users. The modular and lightweight design of components for the PRO-8 Series allows for fast and easy installations.

Part #	Description	Price
50042	Sleeve, Flush Floor Mount (existing concrete)	
50054	Sleeve, Floor Mount	
50046	Cap, Sleeve (CS-500)	
50140	Tuff Glide Rail System, 120R-364H-32R-2A	
50166	Tuff Glide Rail System, 86R-240H-32R-2A	
70541	Davit, Pro-3 Anchor, 120R-391H (Steel, 2pc)	
70374	Davit, Pro-3 Anchor, 120R-273H (Steel, 1pc)	



PT# 70374

Cube Systems utilize a concrete filled steel box as ballast to support a Davit 32ft ( 9.75m) tall, and smaller. A rail can be attached to multiple davits on one cube base or spanned over multiple cube bases to provide overhead anchor points.

With a variety of base options available, cube systems can be moved around easily at a worksite / facility. The base options can accommodate for a variety of worksite conditions.



**PRO-7 Cube System Accessories**

Part #	Description	Price
70187	Forklift Pockets	
70543	Stabilizer Base(adds 8.00" to height) for Hard Terrain	
70497	Trailer/Dolly Heavy Duty ( adds 6.00" to height)	
70516	Kit, Leveling for Large EU Stabilizer (Pt# 70532)	
70692	Large Stabilizer Base (adds 8.00" to height) for Soft Terrain	
70528	Kit, Bolt-on Leveling (to be used ONLY with 70225 with 70516, not shown)	

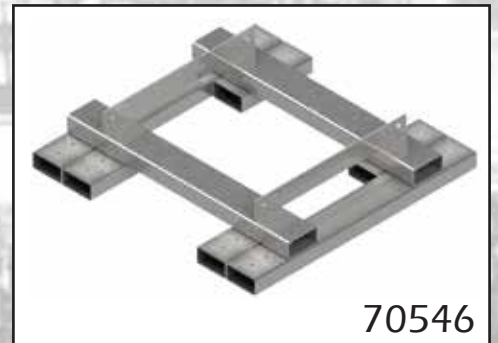
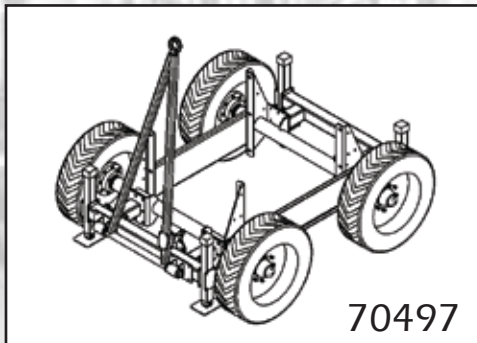
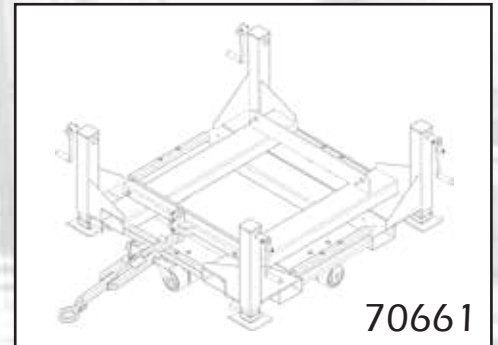
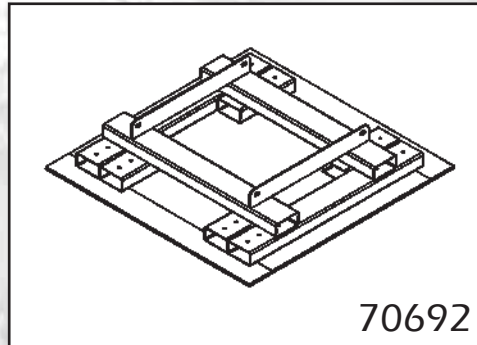





# Hand Railing Systems and Accessories

Tuff Built Products Inc's "Tuff-Guard" Hand Railing System is a versatile product that can adapt to a variety of applications, eg: fall protection along roof edges and safe movement on inclined roofs.

The lightweight construction and interchangeable design of components allows for a wider range of uses and applications.

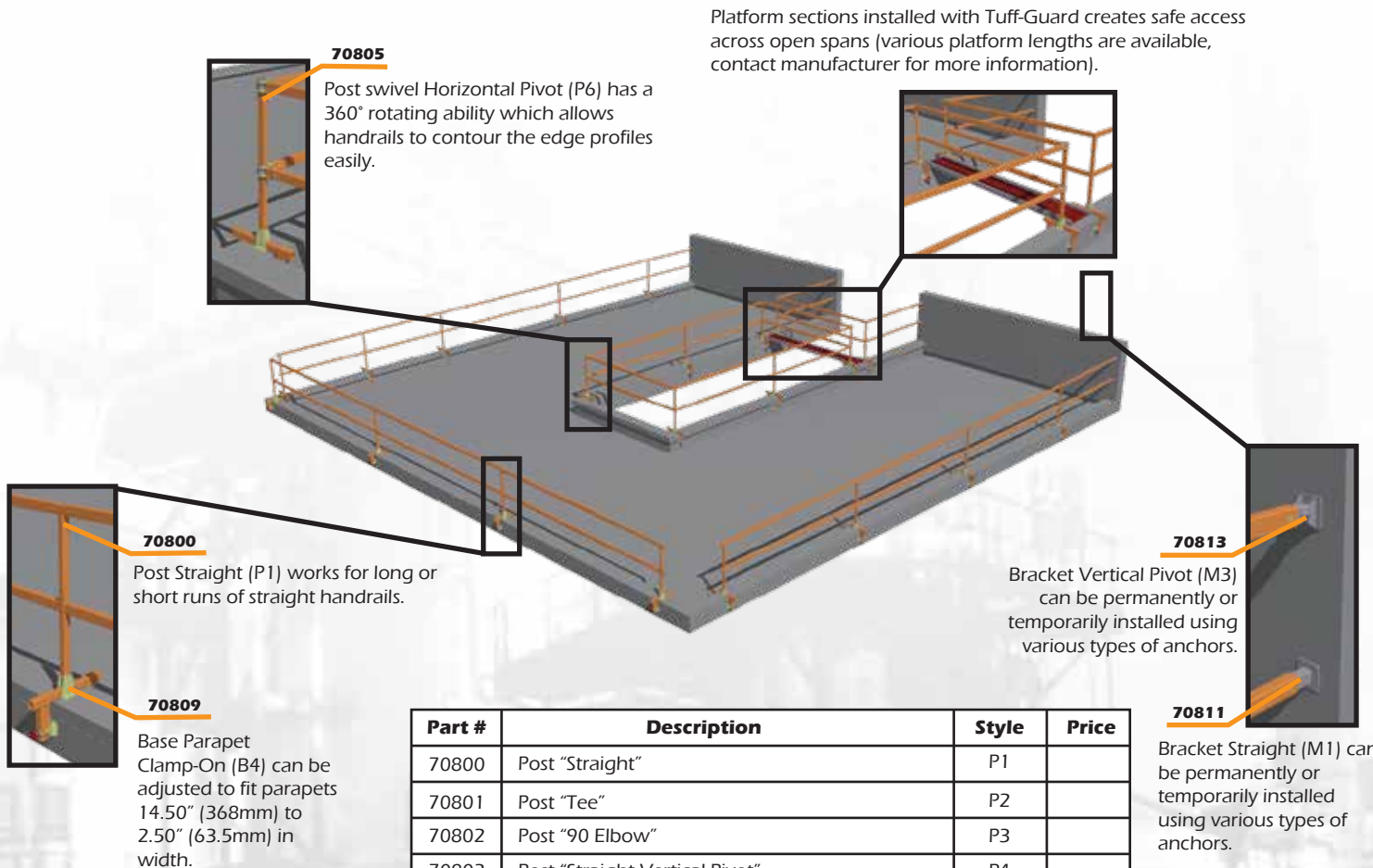

Part #	Description	Style	Price
70800	Post "Straight"	P1	
70801	Post "Tee"	P2	
70802	Post "90 Elbow"	P3	
70803	Post "Straight Vertical Pivot"	P4	
70804	Post "Tee Vertical Pivot"	P5	
70805	Post "Swivel Horizontal Pivot"	P6	
70806	Base, Bolt-On (Steel)	B1	
70807	Base, Bolt-On (Alum)	B2	
70810	Base, Counterweight Rack	B5	
70811	Bracket, "Straight" Wall Mount	M1	
70812	Bracket, "Horizontal Pivot" Wall Mount	M2	
70813	Bracket, "Vertical Pivot" Wall Mount	M3	
70814	Handrail Tube 2 ft (24"/610mm); 2 Length	R2	
70815	Handrail Tube 4 ft (48"/1219mm); 2 Length	R4	
70816	Handrail Tube 6 ft (72"/1829mm); 2 Length	R6	
70817	Handrail Tube 8 ft (96"/2438mm); 2 Length	R8	
70818	Handrail Tube 10 ft (120"/3048mm); 2 Length	R10	
70819	Handrail Tube 12 ft (144"/3658mm); 2 Length	R12	
70820	Handrail 14 ft (168"/4267mm); 2 Length	R14	
70821	Adjustable Handrail Tube 10ft to 18 ft; 2 Length (84" to 144"/2134mm to 3658mm)	R1018	
70822	Adjustable Handrail Tube 7 ft to 12 ft; 2 Length (84" to 144"/2134mm to 3658mm)	R712	

**Hand rails are available in 2ft increments, also available are adjustable sections of 7ft to 12 ft and 10ft to 18ft.**

## Portable / Permanent Guardrail System

The Portable Guardrail system provides a passive fall protection system for workplace safety. It's unique design allows it to be used as a portable or permanent full perimeter system. This guardrail system provides long-lasting fall protection for maintenance and roofing applications.

Permanent guardrails do not have to be unsightly. Available in a traditional safety yellow or custom color, you are sure to find a guardrail that compliments your building's exterior aesthetic.

- Permanent fall protection.
- Versatile and Easily Adaptable
- Easy to install.
- Pre-engineered mounting system.
- Custom colors to match building components.
- Hot Dipped Galvanized.
- Meets and Exceeds OSHA CFR 29 1926.50, OSHA CFR 29 1910.23 and ICC Codes.

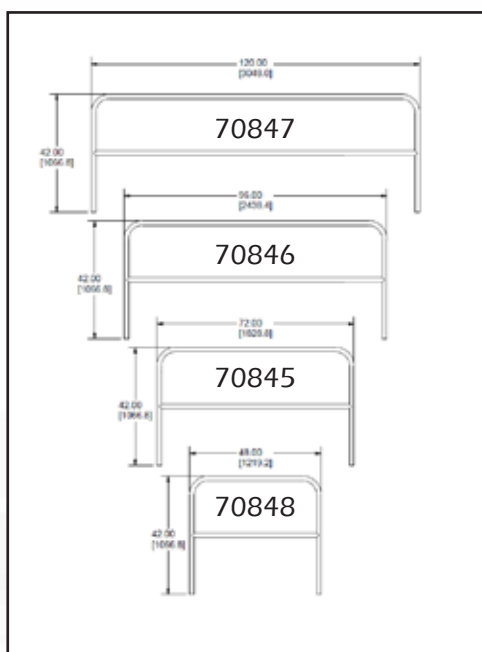

Part #	Description	Weight	Price
70833	Guardrail Base, Counterweight (9 post)	97lbs (44.1kgs)	
70834	Guardrail Base, Counterweight (6post)	45lbs (20.5kgs)	
70843	Guardrail Base, Counterweight (3 post)	42lbs (19.1kgs)	
70844	Guardrail Base, Counterweight (4 post)	43lbs (19.5kgs)	
70847	Guardrail 10ft, Galvanized	44lbs (20kgs)	
70846	Guardrail 8 ft, Galvanized	37lbs (16.8 kgs)	
70845	Guardrail 6ft, Galvanized	31lbs (14.1)	
70848	Guardrail 4ft, Galvanized	23.5lbs (10.7kgs)	
70850	Guardrail Base, Bolt-On (2 post)	3.7lbs (1.68kgs)	
70849	Guardrail Base, Bolt-On (1 post)	1.85lbs (0.84kgs)	

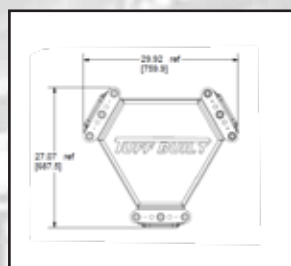

70833

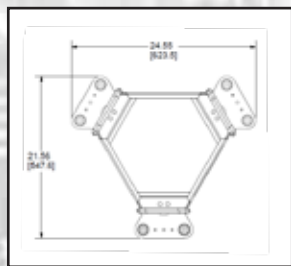

70834

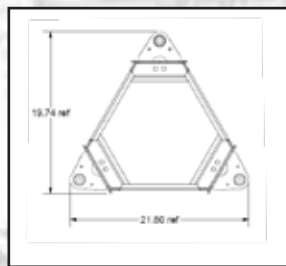

70843

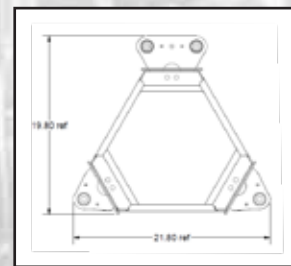

70844

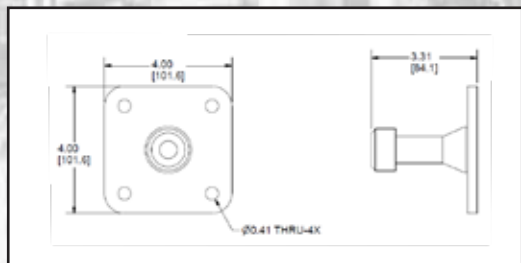

70849

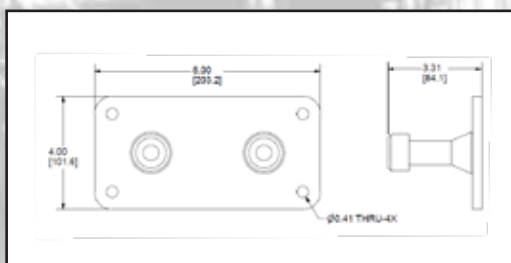

70850

# Horizontal Rail and Trolley Systems

Tuff Built Product's "Tuff-Glide" Horizontal Rail and Trolley System is a modular rail and trolley system designed for overhead installation to new or existing structure to provide overhead anchor points for personal fall protection.

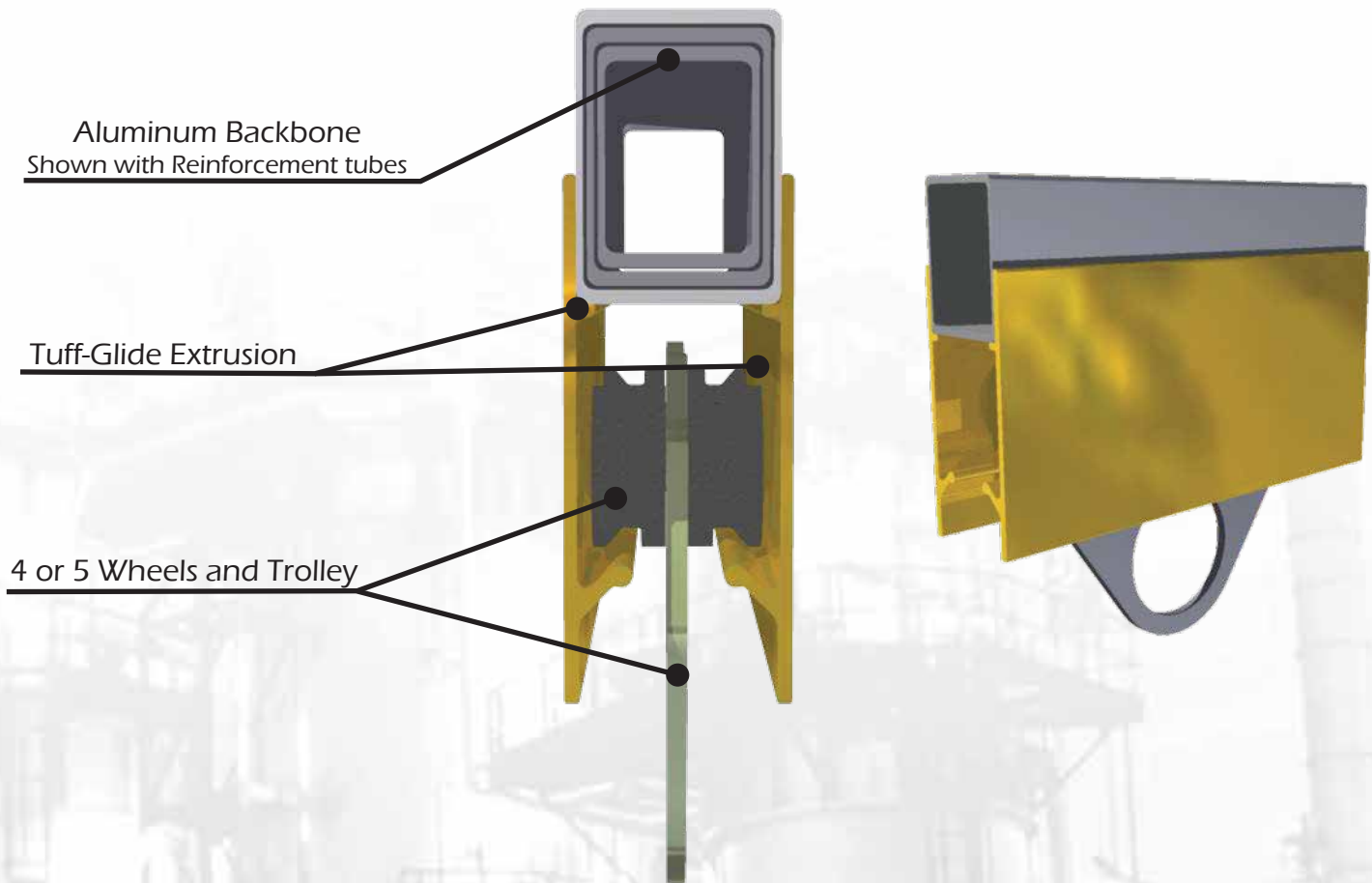



## Horizontal Rail and Trolley Systems

Part #	Description	Weight	Price
70050	Tuff-Glide, 1 ft Rail (2 pieces of track & 1 piece of tube)	2.8lbs(1.3kgs)	
70051	Trolley, 3.25" eye (304 SS)	3.6lbs(1.6kgs)	
70052	Trolley, 3.25" eye (304 SS)	3.3lbs(1.5kgs)	
70055	Trolley, 3.25" eye (Mild Steel CS-500)	3.6lbs(1.6kgs)	
70056	Trolley, 3.25" eye (Mild Steel CS-500)	3.3lbs(1.5kgs)	
70060	Bracket, Tuff-Glide Swivel Hanger 2"-2.5" (5cm-6.3cm)	4.8lbs(2.2kgs)	
70061	Bracket, Tuff-Glide Mtg Rail 2" (5cm)	5.0lbs(2.3kgs)	
70062	Bracket, Tuff-Glide Hanger 2" (5cm)	2.7lbs(1.3kgs)	
70067	Trolley, 5/8" eye (Mild Steel CS-500)	2.8lbs(1.3kgs)	
70079	Trolley, 5/8" eye with Bumper	5.3lbs(2.4kgs)	

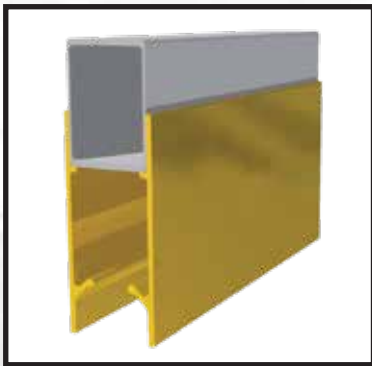

Pt# 70050



Pt# 70052



Pt# 70055



Pt# 70060



Pt# 70061

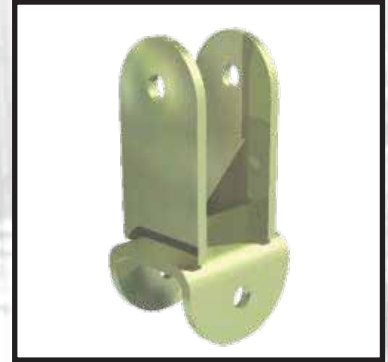

Pt# 70062

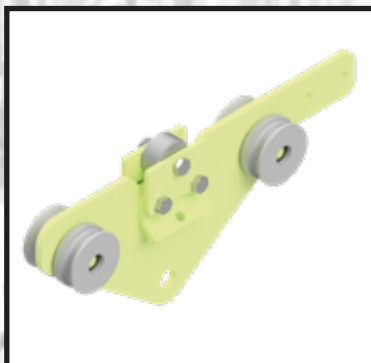

Pt# 70067

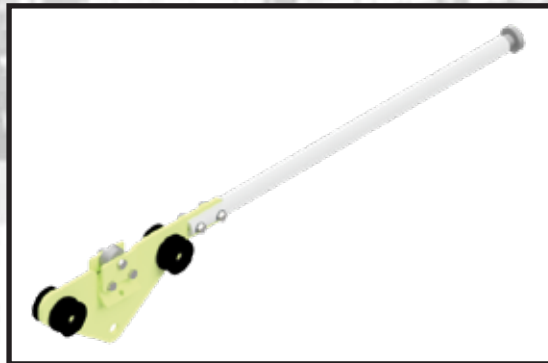

Pt# 70079



# Rescue Systems and Accessories

## Pro-4 Tripod Rescue (10ft-3 Stage)

Tuff Built Product's Pro-4 Series Tripod Rescue system combines a fully functional tripod with a support structure for cantilever rescue operations. The rescue system features "Tuff-Klik" pin-less adjustment, which eliminates lost or damaged locking pins.



**Pro-4 Rescue Tripod shown being used as standard Tripod setup**



**Pro-4 Rescue Tripod shown being used in a cantilever setup**

Package	Package Contains		Winch	SRL	SRL Bracket	Structure Bracket	Price
20008	Pro-4 Tripod Rescue 10ft- 3Stage	PT# 30102	-	-	-	-	
	Pro-4 Tripod Rescue Base	PT# 30103	-	-	-	-	
	Pro-4 Tripod Rescue Foot(3 Pieces)	PT# 30078	-	-	-	-	
20029	Rescue Tripod w/Winch and Winch Brackets		60217	-	-	60101	
20030	Rescue Tripod w/Winch, Winch Brackets, SRL, SRL Brackets		60217	60057	60154	60101 (2x)	
20031	Rescue Tripod w/SRL and SRL Brackets		-	60057	60154	60101	
20032	Rescue Tripod w/Hanging SRL		-	60055	60035	-	
20033	Rescue Tripod w/ Winch, Winch Brackets, and Hanging SRL		60217	60055	60035	60101	

Rescue Struts



Pro-1 Rescue Strut 8ft shown in application

Tuff Built’s unique, lightweight and patent pending pin-less rescue struts are designed to provide economic solutions for motor vehicle accident scenes where vehicle stabilization is required.

Part #	Description	Weight	Collapsed Length	Max. Extended Length	Price
30100	Pro-1 Rescue Strut 8 ft (2.43m)	26.3 lbs (11.9kgs)	3' 11" (0.95m)	8' 2" (2.50m)	
30101	Pro-1 Rescue Strut 14 ft (4.26m)	33.7 lbs (15.2kgs)	5' 1" (1.55m)	14' (4.27m)	

Manhole Collar

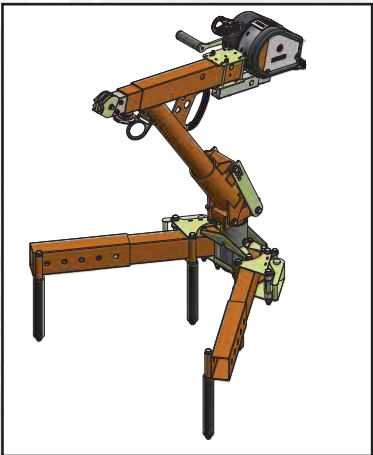

The Manhole Collar is designed for flat or angled manholes in a confined working space. The manhole collar base is equipped with an adjustable sleeve.

Part #	Description	Weight	Price
20093	Pkg: Manhole Collar, Winch, and Davit	125 lbs (57 kgs)	
30308	Base, Manhole Collar (18" to 36")	48 lbs (22 kgs)	
30310	Sleeve, Adjustable Manhole Collar	17 lbs (7.7kgs)	
30311	Davit, Pro-3 Manhole Collar	26 lbs (11.8 kgs)	

Rescue Platform

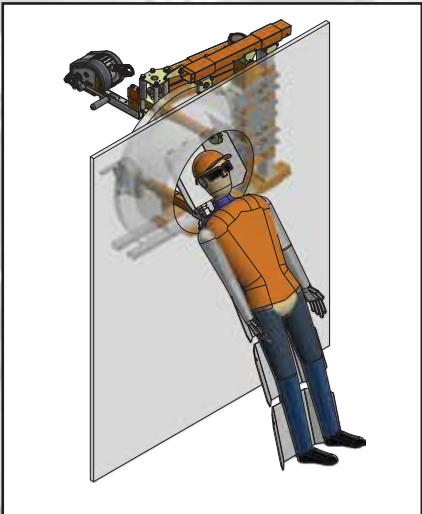

The Rescue Platform is designed to be used in conjunction with a horizontal entry system (PT# 20073). The purpose for the Rescue Platform is to assist in the extraction of an unconscious worker from a confined space.

Part #	Description	Weight	Price
30288	Horizontal Entry Rescue Platform	55lbs (25 kgs)	

# Portable Fall Arrest Anchor Posts

Tuff Built's PRO-Series Portable Fall Arrest Anchor Posts are designed to anchor to various work surface mounted anchor plates, including the Uni-Anchor style plates widely provided by other manufacturers.



Part #	Description	Anchor Points	Height Max. ft ( m )	Height Collapsed ft ( m )	Weight lbs ( kgs )	Price
30147	Tripod, PRO-2	2	14'-3" (4.28)	5'-11" (1.83)	66 (30)	
30137	Tripod, PRO-3	3	4'-7" (1.39)	2'-6" (0.76)	33 (15)	

Designed for use on transformers or similar elevated surfaces, the PRO-3 Tripod ( PT# 30137) provides three separate fall protection-rated anchor points in a lightweight portable package that installs quickly without any tools.

## Tripod Safe Working Area

Workers must stay within the Safe Working Area while attached to the Tripod in accordance with the manufacturer's instructions, to ensure protection as intended by the equipment.

Values shown assume the following conditions;

The work surface is at the same elevation as the surface to which the mounting base is installed.

Each worker weighs 310lbs or less, including all clothes, tools and accessories, and is connected to the post using a self retracting lifeline (SRL) with a Maximum Arrest Force (MAF) rating of 900 lbs (4 kN) or less.

For applications not within the parameters given above please contact your supplier / distributor for additional options.

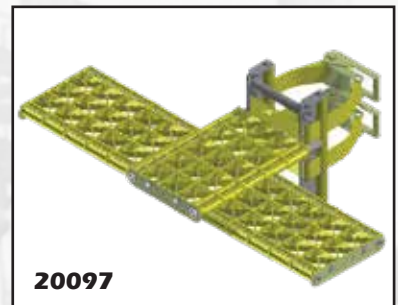

20097



30337



20125



Part #	Description	Weight lbs ( kgs )	Price
30139	Base Bolt on Tripost	10.3 (4.7)	
30144	Base Weld on Tripost	10.3 (4.7)	
30130	Base Analog Weld on Fall Arrest Post	9.3 (4.2)	
30140	Base Tripost for Analog Base	16.2 (7.4)	
30248	Base Analog Weld on Fall Arrest Post w/ tied off anchor	10.2 (4.6)	
30284	Base Weld on Tripost w/ tied off anchor (1)	10.9 (4.9)	
30285	Base Weld on Tripost w/ tied off anchors (3)	12.4 (5.6)	
30287	Tripost Davit Arm Assembly	14.0 (6.4)	
30149	Base Tripost Mount for Proman Base	12.2 (5.5)	
30184	Base Tripost Mount for Trench Plate (1.25 coil Thread)	37.0 (16.8)	
30337	Pole Stand (7.50 to 36.00)	12.5 (5.6)	
30344	Add-on Step for Pole Stand	4.0 (1.8)	
20097	Package, Pole Stand Assembly (30337 X1, 30344 X2)	23.0 (10.4)	
20125	Package, Pole Stand Assembly (30418 X1, 30344 X2, 30419 X1)	23.0 (10.4)	



**30139**



**30144**



**30130**



**30140**



**30248**



**30284**



**30285**



**30149**



**30184**



# Tuff Step Access Systems and Accessories

Tuff- Step provides safe temporary working access to most sloped surfaces where anchoring is possible. May be used as individual stairs or joined together for longer runs. Possible uses include road/rail embankments, river banks, gravel pits, earth retaining walls, trenching, access to accident sites, construction sites, vehicles, general hilly terrain and temporary access between building levels. Can also provide safe temporary bridging over small holes and uneven terrain.

Common features of Tuff-Step are:

1. Heavy Duty non-slip thermoplastic tread.
2. Open design prevents buildup of ice, snow, and mud.
3. Max load is 550lbs (250kgs) per step.
4. Adjustable slope 0-55 degree (5 position).
5. Unlimited number of steps that may be used together with or without anchors,.



## Single Steps

- Heavy duty non-slip thermoplastic tread.
- Open design prevents buildup of ice, snow, and mud.
- Maximum load is 550lbs (250kgs) per step.
- Adjustable slope 0-55° (5 position).
- Unlimited number of steps may be used together, with or without anchors.



**15004:**  
**Single Narrow Step with Ground Spikes**  
Measures 14x17 in (356x432mm)  
Weight 6.35lbs (2.88kgs)

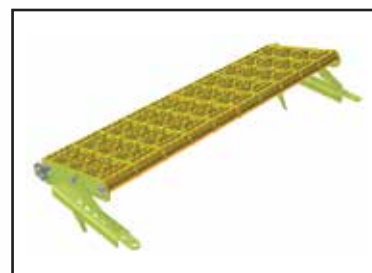

**15005:**  
**Single Wide Step with Ground Spikes**  
Measures 14x31.5 in (356x800.1mm)  
Weight 9.80lbs (4.45kgs)

## Step Sections

- Steps are mounted to Aluminum Support Tubes.
- Maximum load is 550lbs (250kgs) per section.
- Adjustable slope 0-55° (5 position).
- Unlimited number of Step sections may be used together, with or without anchors.



Part #	Description	Price
15006	4 Step Narrow Section	
15007	8 Step Narrow Section	

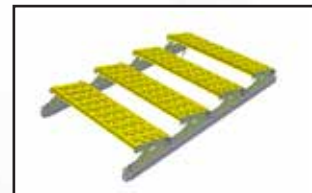

Part #	Description	Price
15008	4 Step Wide Section	
15009	8 Step Wide Section	

## Portable Walkways or Ramps

- Narrow or Wide Steps permanently mounted to aluminum frames, 8, 12, 16 steps per section.
- Steps can fold down to create a flat, non-slip walkway or ramp.
- Maximum load is 550lbs (250kgs) per section.
- Handrail optional.

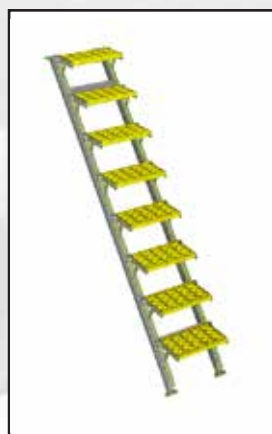
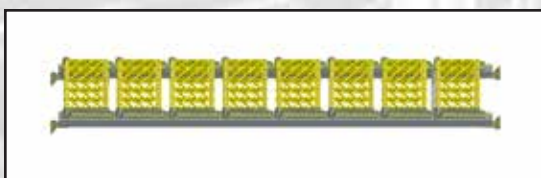

Narrow		
Part #	# steps/ approx. overall length	Price
15011	8/95.00" (2413mm)	
15013	12/141.50" (3594mm)	
15015	16/188.75" (4794mm)	

Wide		
Part #	# steps/ approx. overall length	Price
15018	8/95.00" (2413mm)	
15020	12/141.50" (3594mm)	
15022	16/188.75" (4794mm)	

## Handrails

Handrails, Connection Tubes and Post Assemblies are designed to be used on Step Sections or Portable Walkways/Ramps. Connection Tubes allow users to have Handrails on one or both sides of step assemblies. Handrails are designed to "span" one section to another. Depending on the length or the "run", 1 (one) Connection Tube is required per section.

Item #	Part #	Description	Price
1	15076	Connection Tube (Narrow)	
	15075	Connection Tube (Wide)	
2	15078	Post Assembly	
3	15085	End Rail	
4	15082	Adjustable Handrail (2pcs, 72" to 115" / 1829 to 2921mm)	

\* note: Non-Adjustable Handrails are designed to fit where the Adjustable Handrails can not.

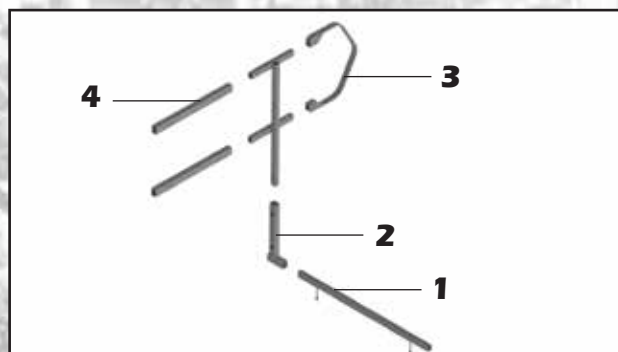



## Para-Stair Narrow Step Systems

Part #	Description	Price
15136	Para-Stair, Top Landing (Narrow Assembly)	
15104	Para-Stair Assembly, 4-NS (Handrails both sides)	
15105	Para-Stair Assembly, 6-NS (Handrails both sides)	
15103	Para-Stair Assembly, 8-NS (Handrails both sides)	
15106	Para-Stair Assembly, 10- NS (Handrails both sides)	
15107	Para-Stair Assembly, 12-NS (Handrails both sides)	
15102	Para-Stair Assembly, 16-NS (8-NS 2X, Handrails both sides)	
15100	Para-Stair Assembly, 20-NS (10-NS 2X, Handrails both sides)	

## Para-Stair Wide Step Systems

Part #	Description	Price
15132	Para-Stair, Top Landing (Wide Assembly)	
15111	Para-Stair Assembly, 4-WS (Handrails both sides)	
15112	Para-Stair Assembly, 6-WS (Handrails both sides)	
15113	Para-Stair Assembly, 8-WS (Handrails both sides)	
15114	Para-Stair Assembly, 10- WS (Handrails both sides)	
15115	Para-Stair Assembly, 12-WS (Handrails both sides)	
15120	Para-Stair Assembly, 16-WS (8-WS 2X, Handrails both sides)	
15121	Para-Stair Assembly, 20-WS (10-WS 2X, Handrails both sides)	

\*Para-Stair Sections come in increments of 4, 6, 8, 10, 12, 15, 20 and 24 steps as one piece assemblies. Multiple step can be attached to each other. i.e. 2 (two) 8 step sections can be attached together to make a 16-step assembly (i.e. PT# 15102)

Para-Stair Systems are self supporting stair for accessing elevated work surfaces.

Para-Stair Systems are designed so that the Stair tread remains level over an operating range of 30° to 60°.



PT# 15102; Para-Stair Assembly, 16-NS  
Consists of 15136 (1X), 15135 (6X), 15137 (1X), 15085 (4X), 15141 (1X).  
Maximum (60°):  
Height 176.50" (4483mm) x Offset 122.63" (3115mm).  
Minimum (30°):  
Height 102.00" (2591mm) x Offset 196.50" (4994mm).

## Para-Stair Common Parts



Part #	Description	Price
15233	Post, Wide Steps	
15137	Para-Stair Bottom Stabilizer (2pcs)	
15133	Para-Stair Top/Bottom Wide Anchor (2pcs)	
15134	Para-Stair Top/Bottom Wide Anchor (1pcs)	
15234	End Loop, Small	
15235	End Loop, Large	
15236	Post, Narrow Steps	
15192	Narrow Support Brace	
15197	Wide Support Brace	
15247	Anchor Top	
15248	Anchor Bottom	

Specifications are subject to change without notice.

## TS Walkway

Tuff Built's NEW "TS Walkway" is designed to provide safe, clean accessibility on job sites where weather and/or heavy equipment has made the ground terrain inaccessible.

Features are:

1. Lightweight
2. Heavy duty, non-slip, UV stabilized polyurethane plastic.
3. Open tread design prevents buildup of ice, snow, and/or mud.
4. Maximum load is 900lbs (409.1 kgs) per sqf.
5. Can be used on slopes up to 20°.

Corner and Tee Walkway sections, along with a variety of handrail and post designs allow for custom layout for your job site.



Part #	Description	Weight	
15161	TS Walkway, 9W X 97.35"	73.0lbs (33.1kgs)	
15162	TS Walkway, 3W Corner 90	28.0lbs( 12.7kgs)	
15163	TS Walkway, 3W Tee	27.0lbs(12.2kgs)	
15165	TS Walkway, Spike	1.2lbs(0.54kgs)	
15166	TS Walkway, Post	5.0lbs(2.3kgs)	
15182	TS Walkway, Outside Corner Post	5.5lbs(2.5kgs)	
15192	TS Walkway, Inside Corner Post	6.0lbs(2.7kgs)	
15183	TS Walkway, Handrail 73.00" (2pcs)	10.6lbs(4.8kgs)	
15184	TS Walkway, Handrail 171.00" (2pcs)	25.0lbs(11.3kgs)	
15185	Adjustable Handrail 97.50" to 150.00" (2pcs)	24.0lbs(11.3kgs)	
15082	Adjustable Handrail 72.00" to 115.00" (2pcs)	17.3lbs(7.8kgs)	
15186	TS Walkway, Connector	0.75lbs(0.35kgs)	

**TS Walkway (PT#15161) comes with 2 pcs of Connector (PT#) 15186).**

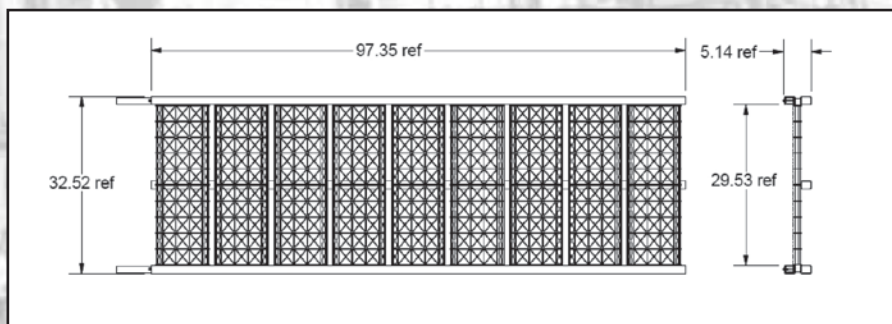



# Exosphere Customizable Portable Fall Protection Anchor Systems

Category

18



**4X4 EXOSPHERE (PROPANE)**



**HIGHWAY TRAILER EXOSPHERE**



**4X4 EXOSPHERE**



**MANUAL HYDRAULIC EXOSPHERE**

**EXOSPHERE ANCHOR**

# Build your Exosphere

Anchor Arms				
<b>A</b>	1	70706	24" Double 360° rotation arms	
	2	70693	10" Triple 360° rotation anchors	
	3	70623	94" Double 360° rotation arms	
	4	70705	48" Quadruple 360° / 180° rotation arms	
	5	70747	48" Double 360° / 180° rotation arms	
	6	70917	72" Double 360° / 180° rotation arms	

Masts				
<b>B</b>	1	70611	Hydraulic 14' two stage	
	2	70612	Hydraulic 18' two stage	
	3	70613	Hydraulic 24' four stage	
	4	70614	Hydraulic 30' four stage	
	5	70615	Hydraulic 38' four stage	
	6	70974	Winch Operated 14' two stage	
	7	70975	Winch Operated 18' two stage	
	8	70976	Winch Operated 24' four stage	

Mounting Brackets				
<b>C</b>	1	70697	Permanent vertical	
	2	70698	Foldable manual (winch only)	
	3	70699	Foldable hydraulic	

Cube Bases				
<b>D</b>	1	70694	3,350 Lbs, used with #70691 & 70501 only	
	2	70695	4,790 Lbs, Cube with concrete	
	3	70696	6,740 Lbs, Cube with concrete	

Lifting Power Devices				
<b>E</b>	1	70700	Winch for 14', 18' & 24'	
	2	70701	Manual Hydraulic for vertical lift only (all bases)	
	3	70702	110 / 220 Hydraulic for vertical lift only (all bases)	
	4	70703	12v hydraulic (12VH) for Highway Trailer only	
	5	70969	Manual Hydraulic for vertical and foldable lift (all bases excluding outdoor push/pull)	
	6	70970	Manual Hydraulic for vertical and foldable lift (outdoor push/pull)	
	7	70971	110 / 220 Hydraulic for vertical and foldable lift (all bases)	
	8	70972	12v Hydraulic for vertical and foldable lift (all bases)	
	9	70973	12v Hydraulic for vertical only (all bases)	

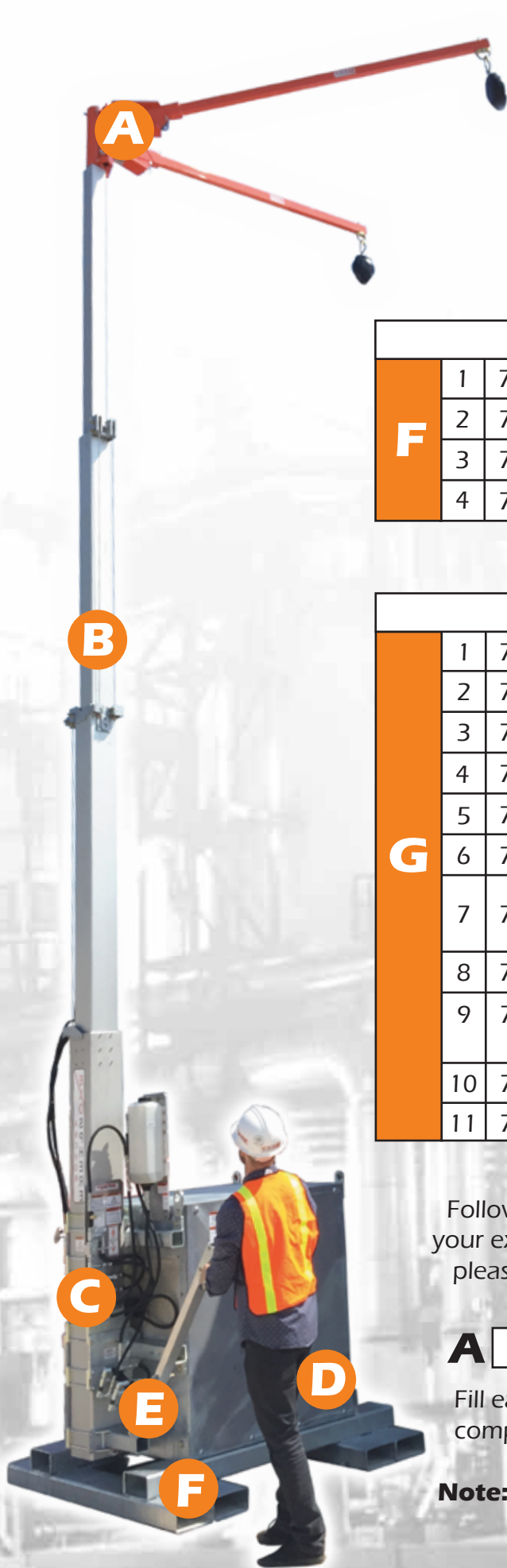

### Stabilized Transport Bases

F	1	70497	Transport base for soft terrain (outdoor push/pull)	
	2	70546	Stabilizer base for concrete	
	3	70661	Transport base for finished floor (indoor push/pull)	
	4	70692	Stabilizer base for soft terrain	

### Accessories

G	1	70988	Anchor Point Adjustable	
	2	70990	Lighting Mounting Arm (up to 4 lights)	
	3	70991	Lighting 50" LED 288W (2pc) with Reel	
	4	70992	Lighting Generator (3000W, Gasoline)	
	5	70987	25 US Gallon Fuel Tank (70501 only)	
	6	70881	Leveling Kit for Vertical (30/38' only)	
	7	70989	Non-Marking Orange Tire Upgrade (70497 & 70501 only)	
	8	70516	Leveling kit for Foldable (70546 & 70612 only)	
	9	70690	Leveling kit for Vertical (70546 & 70612 only)(18/24' only)	
	10	70968	Propane Conversion (70501 only)	
	11	70895	Solar Panel kit (12V only)	

Follow the example provided below to create a custom code for your exosphere. When contacting a sales representative/distributor please use the code to ensure ease of pricing and/or drawings.

**A**  - **B**  - **C**  - **D**  - **E**  - **F**  - **G**

Fill each square with the corresponding number desired. Once completed you will have created your custom exosphere code.

**Note:** Premade packages are also available in categories 19 & 20.



# Complete Packages

## For Concrete Surfaces

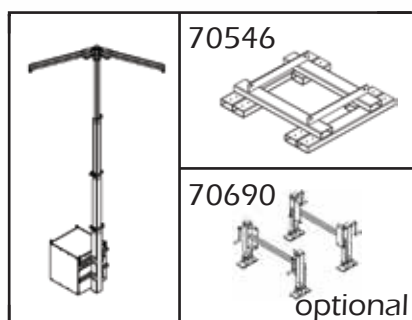

Part #	Max. Height	Anchor points	Part # components	Price
70710	14	2	70623, 70611, 70697, 70696, 70701(MH), 70546	
70711	18	2	70623, 70612, 70697, 70696, 70701(MH), 70546	
70712	24	2	70623, 70613, 70697, 70696, 70701(MH), 70546	

## For Soft Surfaces

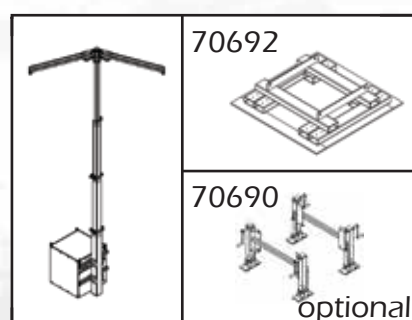

Part #	Max. Height	Anchor points	Part # components	Price
70716	24	2	70623, 70613, 70697, 70696, 70701(MH), 70692	
70717	38	2	70623, 70615, 70697, 70696, 70701(MH), 70692	

## For Indoor: Push/pull

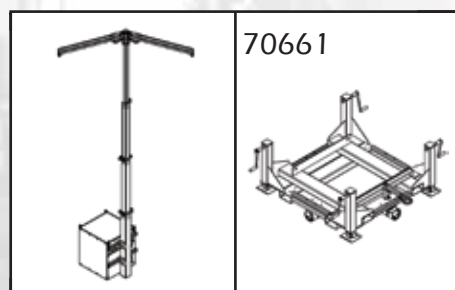

Part #	Max. Height	Anchor points	Part # components	Price
70718	18	2	70623, 70612, 70697, 70696, 70701(MH), 70661	
70719	24	2	70623, 70613, 70697, 70696, 70701(MH), 70661	
70635	38	2	70623, 70615, 70697, 70696, 70701(MH), 70661	

## For Outdoor: Push/pull

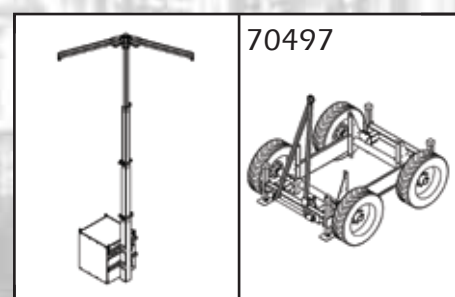

Part #	Max. Height	Anchor points	Part # components	Price
70721	24	2	70623, 70613, 70697, 70694, 70701(MH), 70497	
70722	30	2	70623, 70614, 70697, 70694, 70701(MH), 70497	
70723	38	2	70623, 70615, 70697, 70694, 70701(MH), 70497	



## For Concrete Surfaces

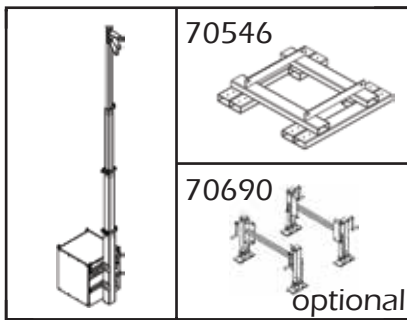

Part #	Max. Height	Anchor points	Part # components	Price
70727	14	3	70693, 70611, 70697, 70696, 70701(MH), 70546	
70728	18	3	70693, 70612, 70697, 70696, 70701(MH), 70546	
70729	24	3	70693, 70613, 70697, 70696, 70701(MH), 70546	

## For Soft Surfaces

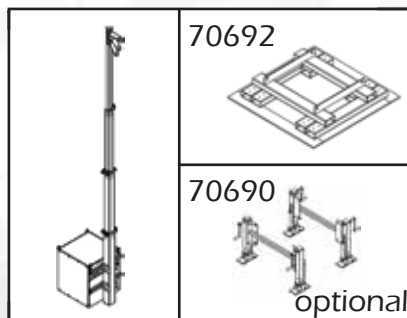

Part #	Max. Height	Anchor points	Part # components	Price
70733	24	3	70693, 70613, 70697, 70696, 70701(MH), 70692	
70734	38	3	70693, 70615, 70697, 70696, 70701(MH), 70692	

## For Indoor: Push/pull

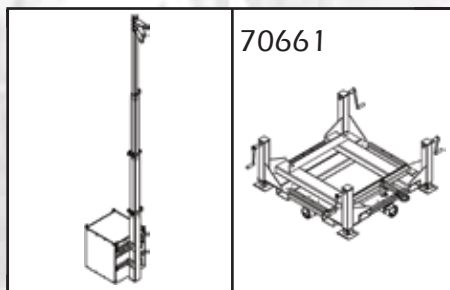

Part #	Max. Height	Anchor points	Part # components	Price
70735	18	3	70693, 70612, 70697, 70696, 70701(MH), 70661	
70736	24	3	70693, 70613, 70697, 70696, 70701(MH), 70661	
70737	38	3	70693, 70615, 70697, 70696, 70701(MH), 70661	

## For Outdoor: Push/pull

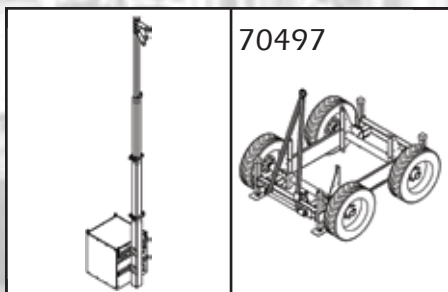

Part #	Max. Height	Anchor points	Part # components	Price
70738	24	3	70693, 70613, 70697, 70694, 70701(MH), 70497	
70739	30	3	70693, 70614, 70697, 70694, 70701(MH), 70497	
70740	38	3	70693, 70615, 70697, 70694, 70701(MH), 70497	

Note: Other complete packages available ~ Please call 1-877-422-6053 for more information

# Specifications

## Push/Pull indoor heavy duty PT#70661

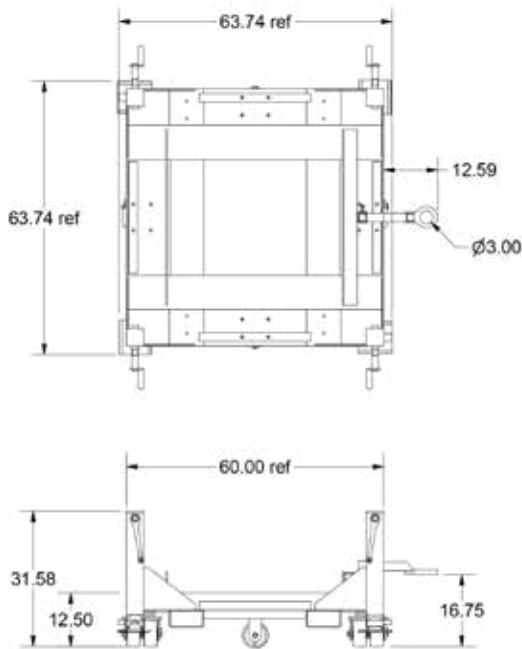

Weight (est) 1020 lbs (462.7 kgs)

## Push/Pull outdoor heavy duty PT#70497

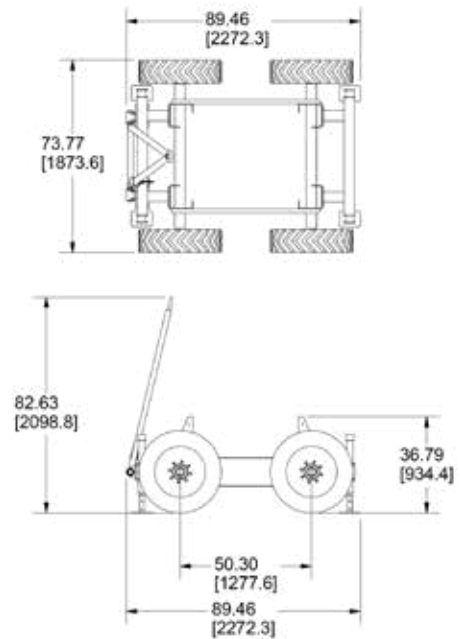

Weight (est) 1700.0 lbs (772.7 kgs)

## Regular: for concrete PT#70546

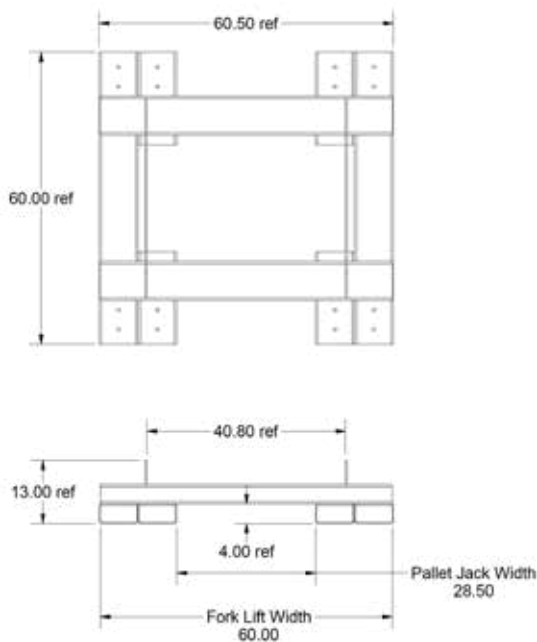

Weight (est) 550.0 lbs (250.0 kgs)

## Wide base for soft terrain PT#70692

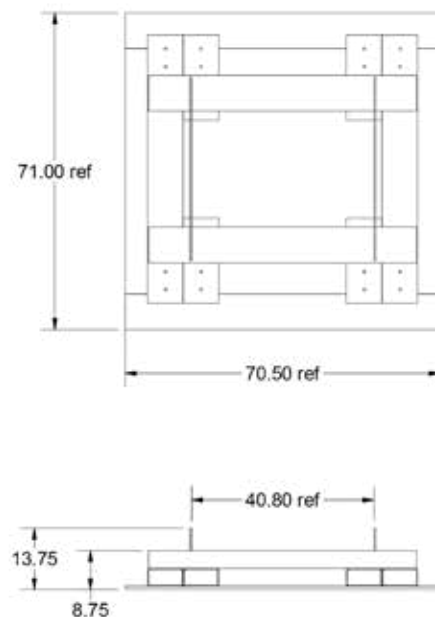

Weight (est) 598.0 lbs (271.8 kgs)

# Specifications

50" LED Lighting  
PT#70916

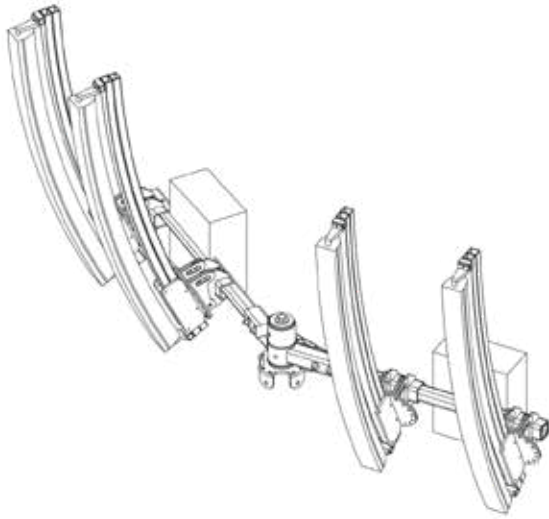

Weight (est) 700.0 lbs (317.5 kgs)

Leveling Kit  
PT#70690

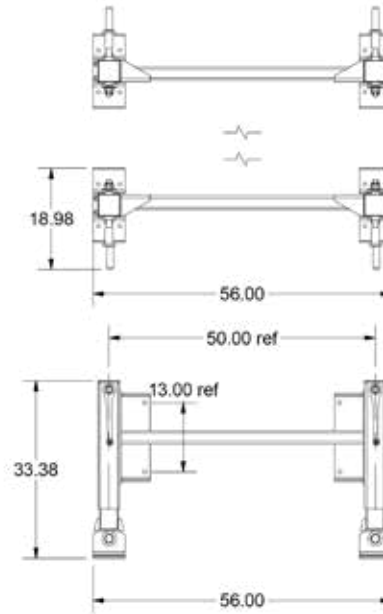

Weight (est) 447.0 lbs (203.2 kgs)

18' Mast  
PT#70612

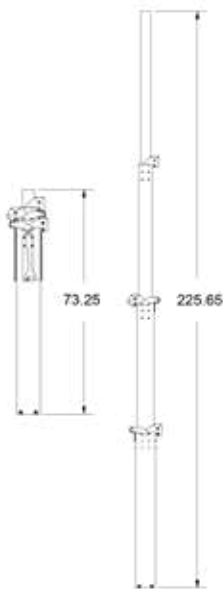

Weight (est) 184.0 lbs  
(83.6 kgs)

24' Mast  
PT#70613

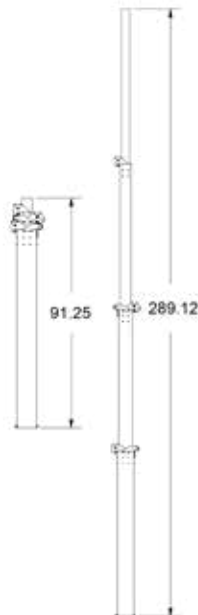

Weight (est) 221.0 lbs  
(100.5 kgs)

38' Mast  
PT#70615



Weight (est) 312.0 lbs  
(141.8 kgs)



# Exosphere Highway Trailer Fall Protection Anchor System



## Before you buy, look for this mark.

Trailer manufacturers proudly displaying the NATM Compliance Decal signify they comply with established industry standards and U.S. DOT's federal motor vehicle safety standards and regulations.

**It is the mark of a high standard**

The Exosphere Anchor Highway Trailer System is the solution for workers exposed to fall arrest hazards in industries across the country, where traditional products just can not handle the job. This is a versatile system that will increase productivity, reduce lost time, and prevent injuries. All while guaranteeing the absolute highest level of fall protection.

The Exosphere Anchor Highway Trailer system is a self-contained 12V Electric/Hydraulic system that is operated via simple valve operation. Setup and Anchor height adjusting is all carried out with simple to follow controls.

Unprecedented 4 stage telescoping mast, adjustable 42 ft (12.8m) anchor point height and a variety of anchor options; 1-4 person, 54 inch (1.3m) to 94 inch (2.3 m). Heavy duty trailer frame, all four (4) tires are equipped with electric brakes, full size spare tire, emergency break away system, Battery charging system, Heavy duty leveling jacks, Ball Hitch (or pintle) and a manual rescue system are some of the standard features built into the Exosphere Anchor Highway Trailer System.



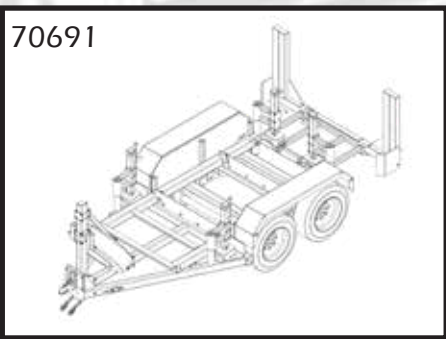
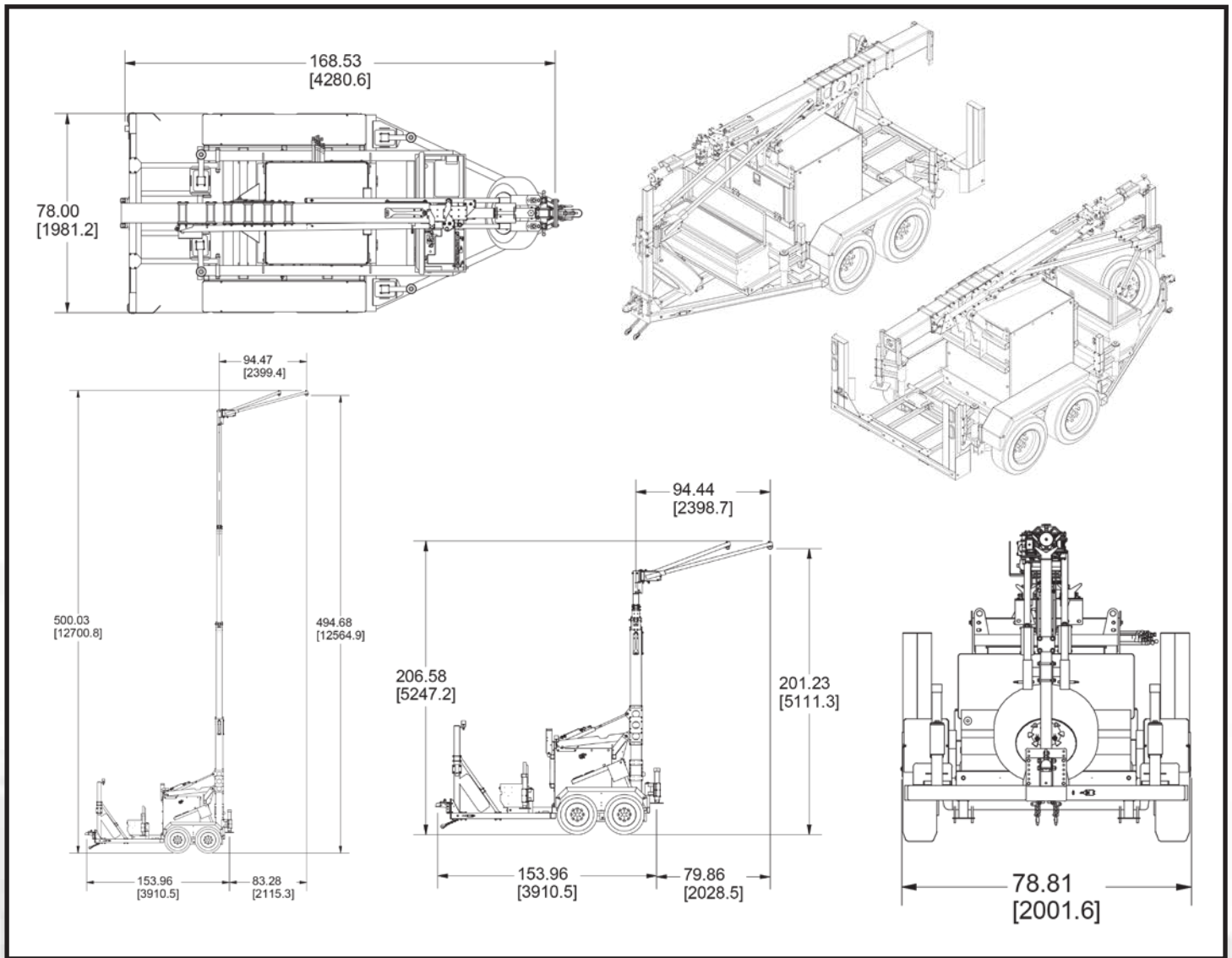

- Heavy Duty steel welded frame
- Full size spare tire
- D.O.T. Approved Lighting
- Four (4) Electric brakes
- Emergency brake away kit
- Adjustable hitch adapter (2-5/16" ball coupler OR 3-1/2" Pintle)
- Two 6000Lbs. capacity axles

Part #	Max. Height	Anchor points	Components	Price
70724	24	2	70623 , 70613 , 70699 , 70694 , 70703 , 70691	
70725	30	2	70623 , 70614 , 70699 , 70694 , 70703 , 70691	
70726	38	2	70623 , 70615 , 70699 , 70694 , 70703 , 70691	
70787	24	2	70747 , 70613 , 70699 , 70694 , 70703 , 70691	
70788	30	2	70747 , 70614 , 70699 , 70694 , 70703 , 70691	
70789	38	2	70747 , 70615 , 70699 , 70694 , 70703 , 70691	
70741	24	3	70693 , 70613 , 70699 , 70694 , 70703 , 70691	
70742	30	3	70693 , 70614 , 70699 , 70694 , 70703 , 70691	
70743	38	3	70693 , 70615 , 70699 , 70694 , 70703 , 70691	

Note: Other complete packages available ~ Please call 1-877-422-6053 for more information

# Exosphere All Terrain 4X4 Fall Protection Anchor System



The Exosphere Anchor 4X4 All-Terrain System is the solution for workers exposed to fall hazards in industries across the country, where traditional products just can not handle the job. This is a versatile system that will increase productivity, reduce lost time, and prevent injuries. All while guaranteeing the absolute highest level of fall protection.

The Exosphere Anchor 4X4 All-Terrain system is a self-contained hydraulic system that is operated via wireless (or wired) remote control. Driving, setup and Anchor height adjusting is all carried out with a simple to follow remote control.

Unprecedented 4 stage telescoping mast, adjustable 42 ft (12.8m) anchor point height and a variety of anchor options; 1-4 person, 54 inch (1.3m) to 94 inch (2.3 m). Heavy duty skid steer tire, four (4) emergency stop switches, audible warning alarm, Hi-vis strobe lights, Heavy duty leveling jacks and a manual rescue system are some of the standard features built into the Exosphere Anchor 4X4 system.

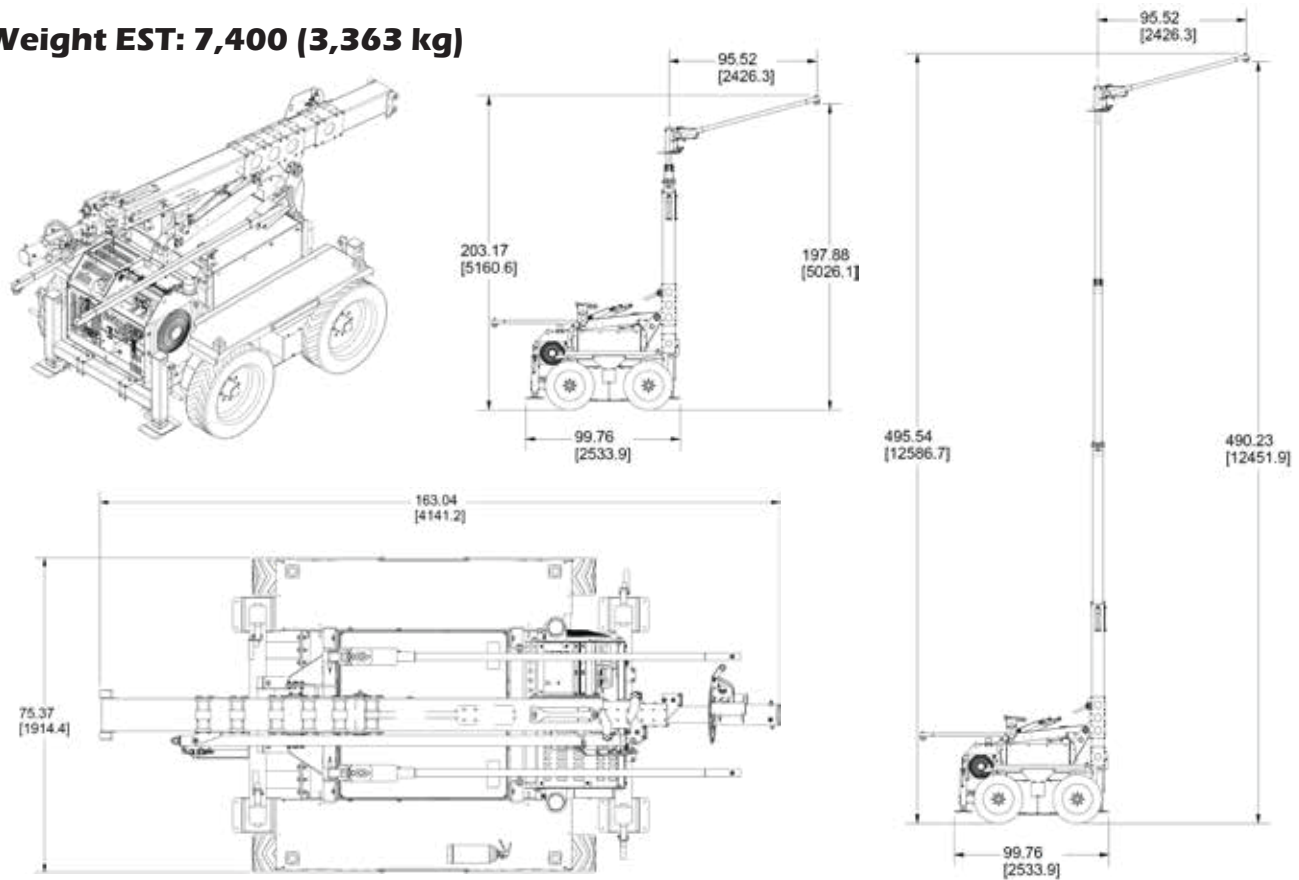

**Weight EST: 7,400 (3,363 kg)**

	Part #	Max. Height	Anchor points	Components	Price
<b>GASOLINE FUELED</b>	70929	24	2	70623 , 70613 , 70699 , 70694 , 70501	
	70919	30	2	70623 , 70614 , 70699 , 70694 , 70501	
	70764	38	2	70623 , 70615 , 70699 , 70694 , 70501	
<b>PROPANE FUELED</b>	70936	24	2	70623 , 70613 , 70699 , 70694 , 70501	
	70926	30	2	70623 , 70614 , 70699 , 70694 , 70501	
	70924	38	2	70623 , 70615 , 70699 , 70694 , 70501	

**FEATURES**

- Wireless Remote Controlled
- Heavy Duty Steel Weld Frame
- Solid Rubber Skid Steer Tires
- Audible Alarm
- Emergency Stops
- Storage Compartment

**Please call for more information**





**TUFF BUILT**  
PRODUCTS INC.  
By  **DIVERSIFIED FALL PROTECTION**

Contact your Diversified safety specialist for more information on our portable and mobile fall protection systems.

[www.FallProtect.com](http://www.FallProtect.com)