

COMPANY: \_\_\_\_\_  
 \_\_\_\_\_  
 \_\_\_\_\_  
 ATTN: \_\_\_\_\_  
 PHONE: \_\_\_\_\_  
 FAX: \_\_\_\_\_



Diversified Fall Protection  
 24400 Sperry Drive Cleveland OH 44145  
 www.fallprotect.com 440-348-9460

## Model A-SM1 FALLGUARD® Skylight Screen

Patent No.  
 5,237,788

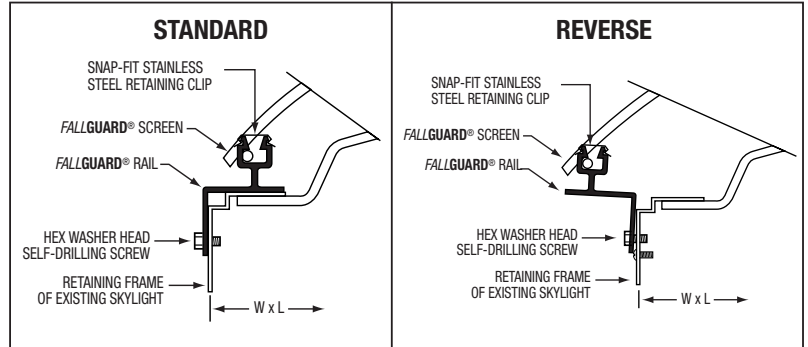
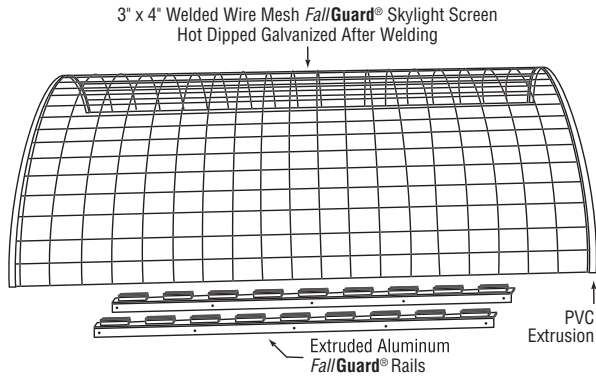

Shown below are some typical retaining frame profiles. Upon receipt of the quantity and dimensions of the clamp, Plasteco, Inc. can readily submit a quotation.

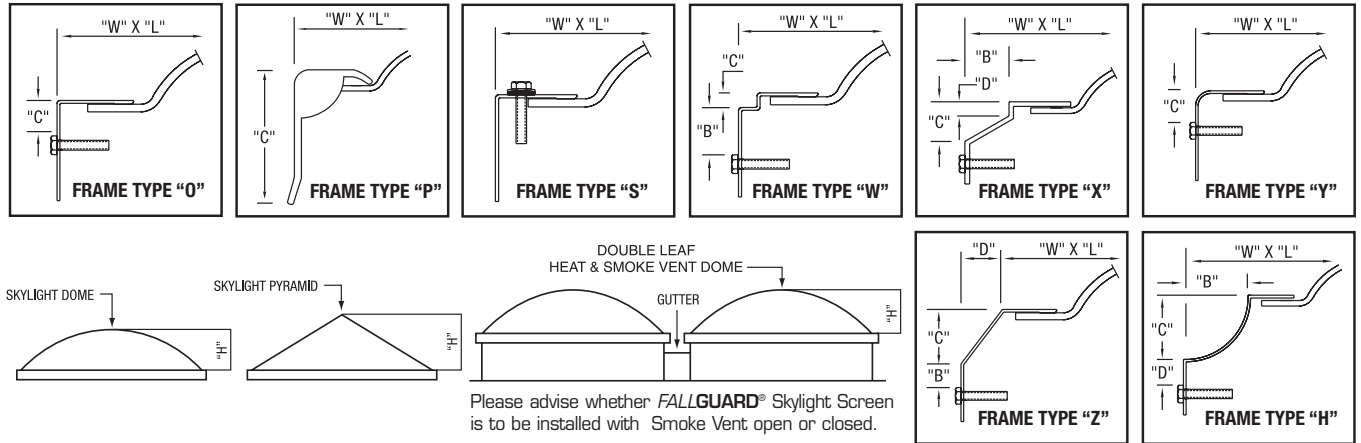

IF YOU WISH A FAXED QUOTATION, PLEASE ENTER RETAINING FRAME DATA HERE AND FAX TO PLASTECO, INC.

FRAME TYPE	DIMENSION "W" x "L"	DIMENSION "B"	DIMENSION "C"	DIMENSION "D"	DOME/PYRAMID "H"	QUANTITY

### Specifications:

The FALLGUARD® Skylight Screen rail shall be fastened to the vertical leg of the retaining frame of the skylight to be retrofitted with galvanized #12 hex washer head self-drilling screw. The FALLGUARD® Skylight Screen shall be 3" x 4" welded steel wire mesh having a minimum transverse (or in the case of a square skylight the curved wire) diameter of .195". The screen shall be hot dipped galvanized to meet ASTM A123 specifications. The FALLGUARD® rails shall be 6061-T6 extruded aluminum with 2" wide notches on 4" centers. After the FALLGUARD® Skylight Screen is installed, a series of 2" wide by 1/2" tall scuppers are created. Where the FALLGUARD® Skylight Screen is longer than the FALLGUARD® rail, a continuous 1/2" opening is created. The exposed ends of the FALLGUARD® Skylight Screen shall be covered with a outdoor PVC extrusion.

### Installation Instructions:

Skylight can be brittle. Do Not Touch Dome.  
 Wear gloves when handling screen. Wear safety glasses when installing FALLGUARD® Rail.

1. Center FALLGUARD® Rail on the retaining frame.
2. Secure the FALLGUARD® Rail with self-drilling special stainless steel hex washer head screws to the retaining frame of the skylight being retrofitted.
3. Install FALLGUARD® Skylight Screen into the FALLGUARD® Rail opening.
4. Install stainless steel clips.